

---

# **OPTiM**

## **Optimal Biz Apple Business Manager (ABM) Operation Manual**

Last update date October 16, 2022  
(Website ver.9.13.1)  
OPTiM Corporation

---

---

# Getting Started

## Purpose of this manual

---

This manual explains the operation of Apple Business Manager (ABM).

## How to read this manual







---

The meanings of symbols and marks used in the explanation of this manual, the types of screens used in manuals, and notes are as follows.

 In this manual, descriptions about iOS devices also apply to iPad OS devices unless otherwise mentioned.

## ◆ About the symbol·mark

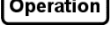
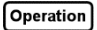
The marks and symbols used in the manual are as follows.

Symbols / mark	Description
[ ]	Represents menu name, button name, and link name.
" "	Represents the name you want to emphasize, such as tab name, function name, item name, reference destination in the manual.
< >	Represents the manual name or the document name.
⇒	Represents the result of the operation.
	Represents the manual or document to be referenced.
	Represents the reference in the manual and the link to the website.
	Explains what to watch out for.
	Explains points of handling and operation and what is convenient to know.
	In the explanation of the screen, describes the menu operation for displaying the corresponding screen. Ex.)  [Settings] → [iOS] → [Application] → [Application Distribution] → 

## ◆ About the screen

- The version notation on the screen may differ from the actual one.
- Some screens and operations may differ depending on the OS version and the browser to be used. In this manual, we explain using the screen displayed in Google Chrome.

## About website URL

---

URLs of websites other than our company described in the manual are subject to change without notice.

## About trademark

---

- iOS and iPad are trademarks of Apple Inc.
  - Company names and product names mentioned are trademarks and registered trademarks of each company.
-

---

## Table of contents

<b>1 Apple Business Manager (ABM)</b> .....	<b>4</b>
1.1 What is Apple Business Manager? .....	5
<b>2 Using "Device" (ADE)</b> .....	<b>6</b>
2.1 Usage flow of "Device" (ADE) .....	7
2.1.1 Downloading server public key file (PEM) .....	7
2.1.2 Acquiring the ADE token .....	8
2.1.3 Registering ADE token .....	16
2.2 Updating ADE token .....	19
2.3 Device management .....	19
<b>3 Using "Contents – Apps and Books"</b> .....	<b>20</b>
3.1 Usage flow of "Contents – Apps and Books" .....	21
3.1.1 Acquiring the Apps and Books Location Token .....	21
3.1.2 Registering the Apps and Books Location Token .....	25
3.2 Updating Apps and Books Location Token .....	28
3.3 Procedure to deliver application/books .....	28
<b>4 Appendix</b> .....	<b>29</b>
4.1 References .....	30
4.2 Cautions .....	30
4.3 Limitations .....	30
4.4 The list of log .....	30

---

# 1 Apple Business Manager (ABM)

Describes the following items.

Item	Page
<a href="#">What is Apple Business Manager</a>	<a href="#">5</a>

## 1.1 What is Apple Business Manager?

---

### ◆ Function purpose

Apple Business Manager (ABM) is an Apple service and web-based IT management tool that began in Japan on August 1, 2018. This allows administrators to configure device settings, and purchase and distribute apps and books to each account they have created.

In the ABM menu, "Devices" corresponds to "Apps & Books" in "Content", Automated Device Enrollment (ADE).

✍ If ADE is already used, it can be upgraded to ABM. If a company only use "Apps & Books", existing persons responsible for "Apps & Books" purchase can be invited to ABM accounts after registered in ABM. Existing "Apps & Books" accounts can be kept. For more information on how to launch new ABM and upgrade it to ABM, visit Apple's website.

---

## 2 Using "Device" (ADE)

Describes the following items.

Item	Page
<a href="#">Usage flow of "Device" (ADE)</a>	<a href="#">7</a>
<a href="#">Updating ADE token</a>	<a href="#">19</a>
<a href="#">Device management</a>	<a href="#">19</a>

## 2.1 Usage flow of "Device" (ADE)

Use "Device" (ADE) of ABM with the following flow.

Item	Page
<a href="#">Downloading server public key file (PEM)</a>	<a href="#">7</a>
<a href="#">Acquiring the ADE token</a>	<a href="#">8</a>
<a href="#">Registering ADE token</a>	<a href="#">16</a>

### 2.1.1 Downloading server public key file (PEM)

Link ABM to Optimal Biz using the ADE token. In order to do that, download server public key file (PEM) required for ABM registration from the management site.

**[1] [Settings]→[iOS]→[ADE]→[Registration for DEP Server Token]→[Edit].**

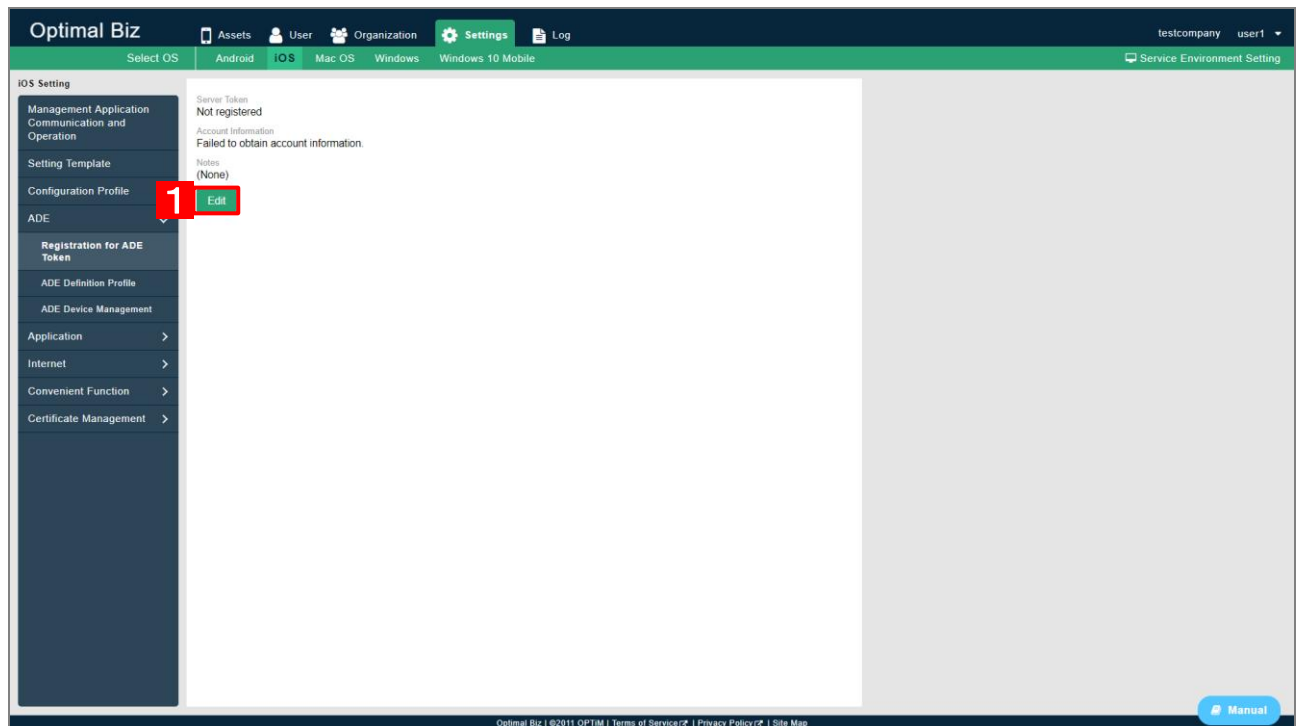

**[2]** Click [Download] in "1. Generate and download server public key (PEM) file" to download the file.

**[3]** Access to <https://business.apple.com> to acquire the ADE token.

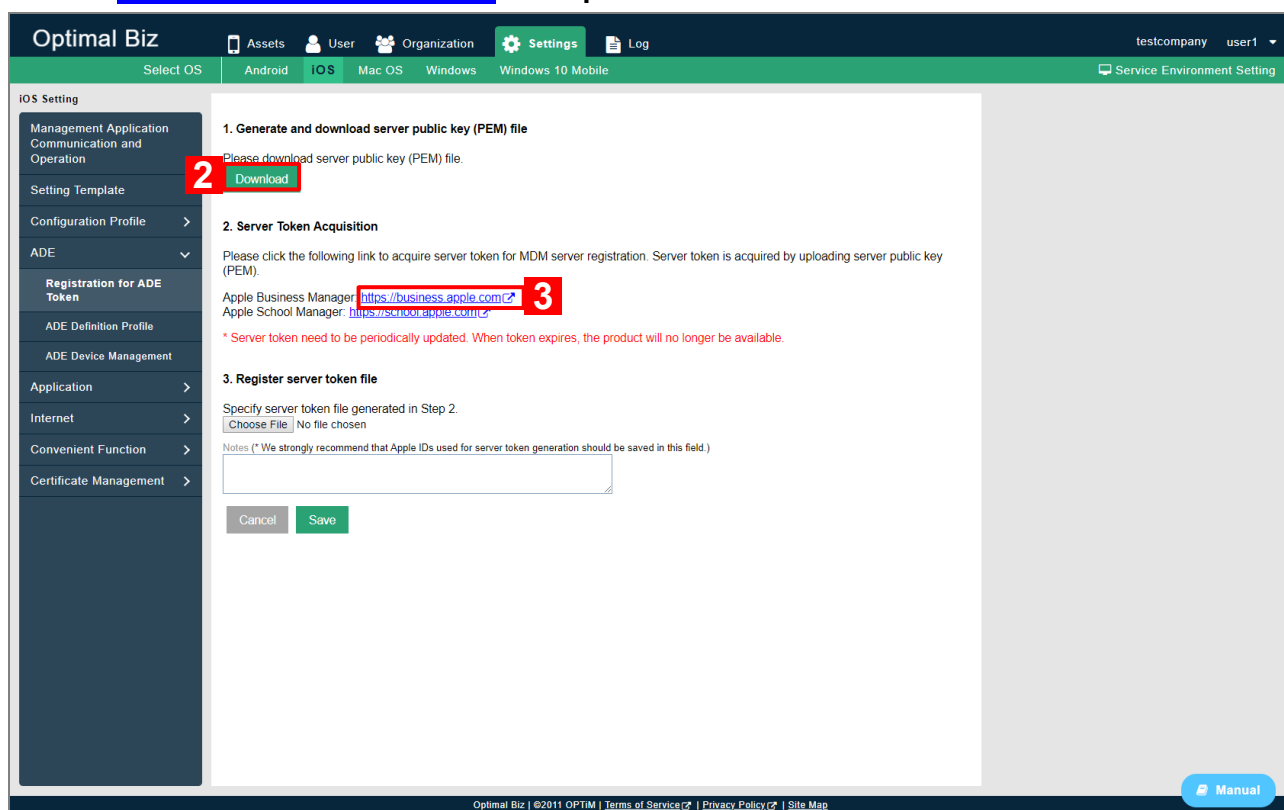

## 2.1.2 Acquiring the ADE token

**[4]** Enter "Apple ID" for administrator.

**[5]** Click .

⇒ A screen for confirming the identity is displayed.

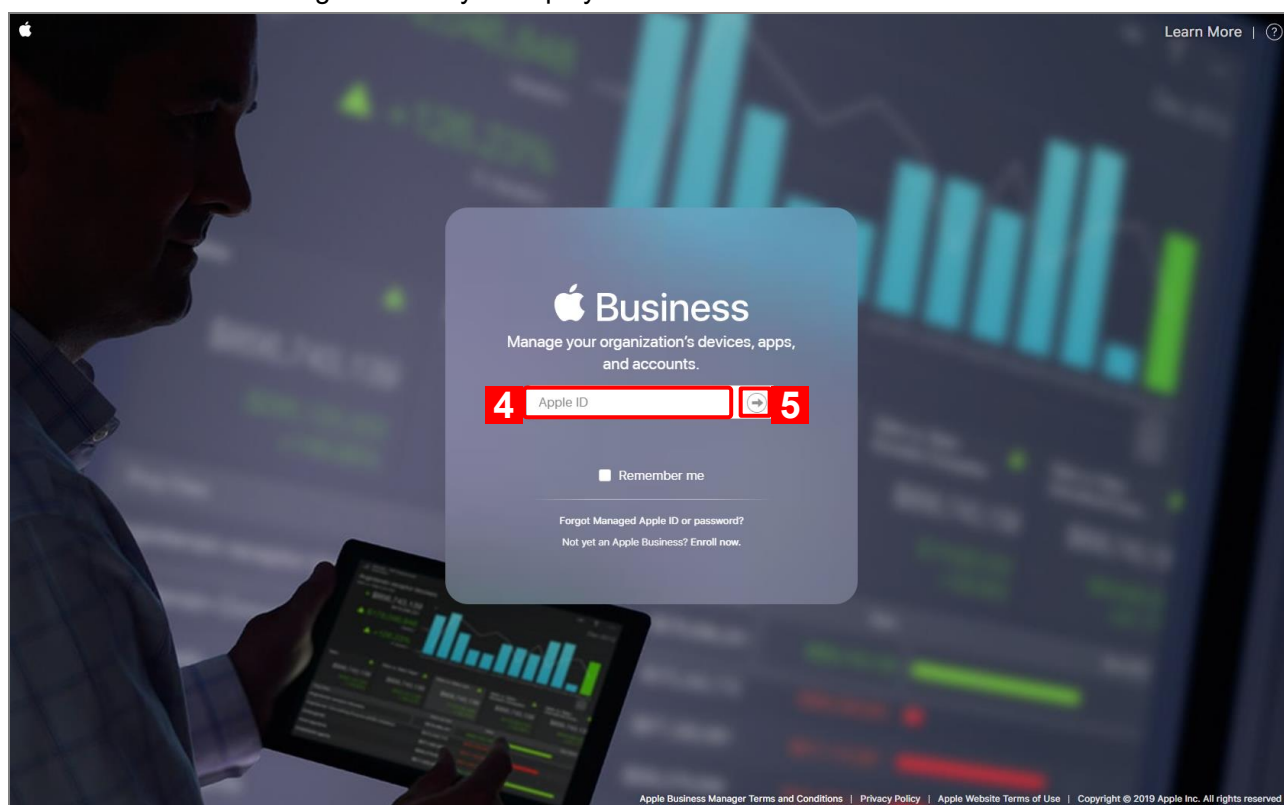



**[6]** As the password field appears, enter the password in it.

**[7]** Click .

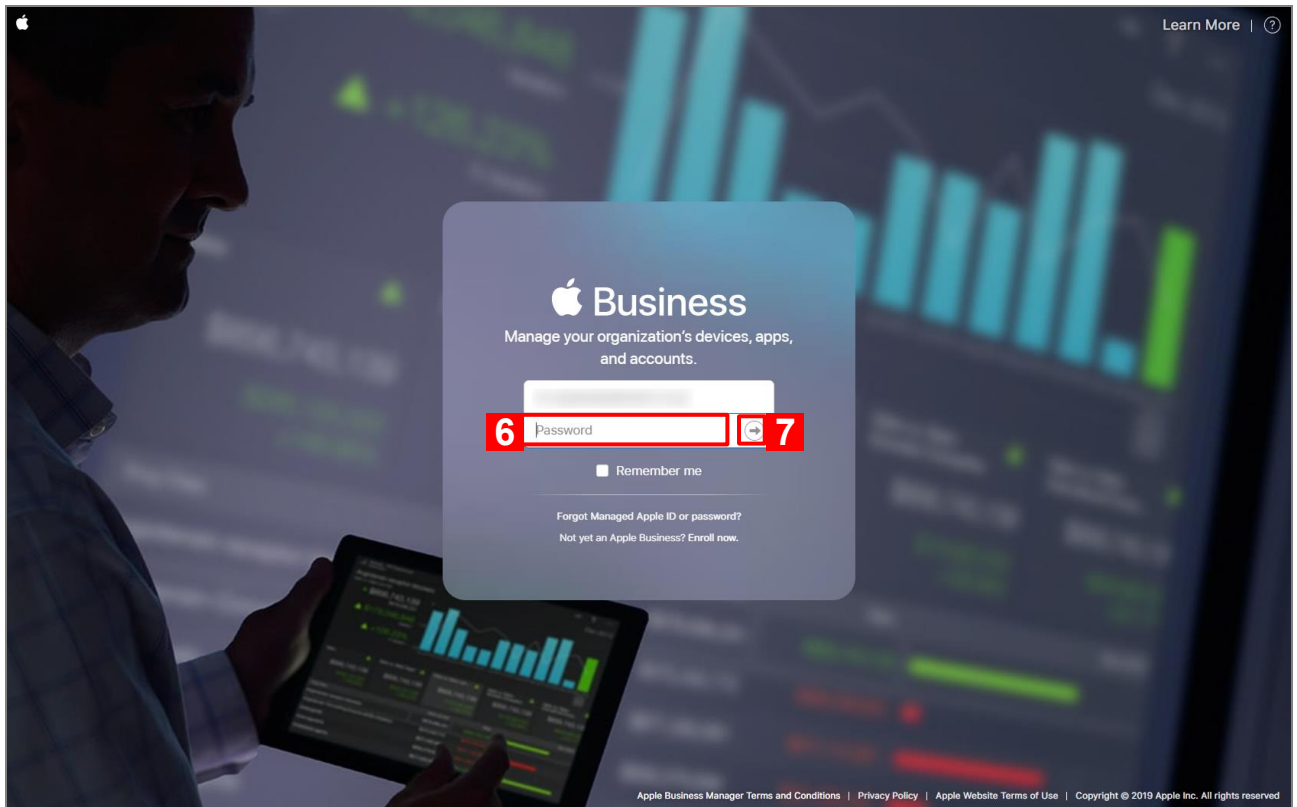

**[8]** Select a destination to which the confirmation code is sent.

⇒ The confirmation code will be sent to the selected destination.

 Choices are displayed when multiple destinations are registered.

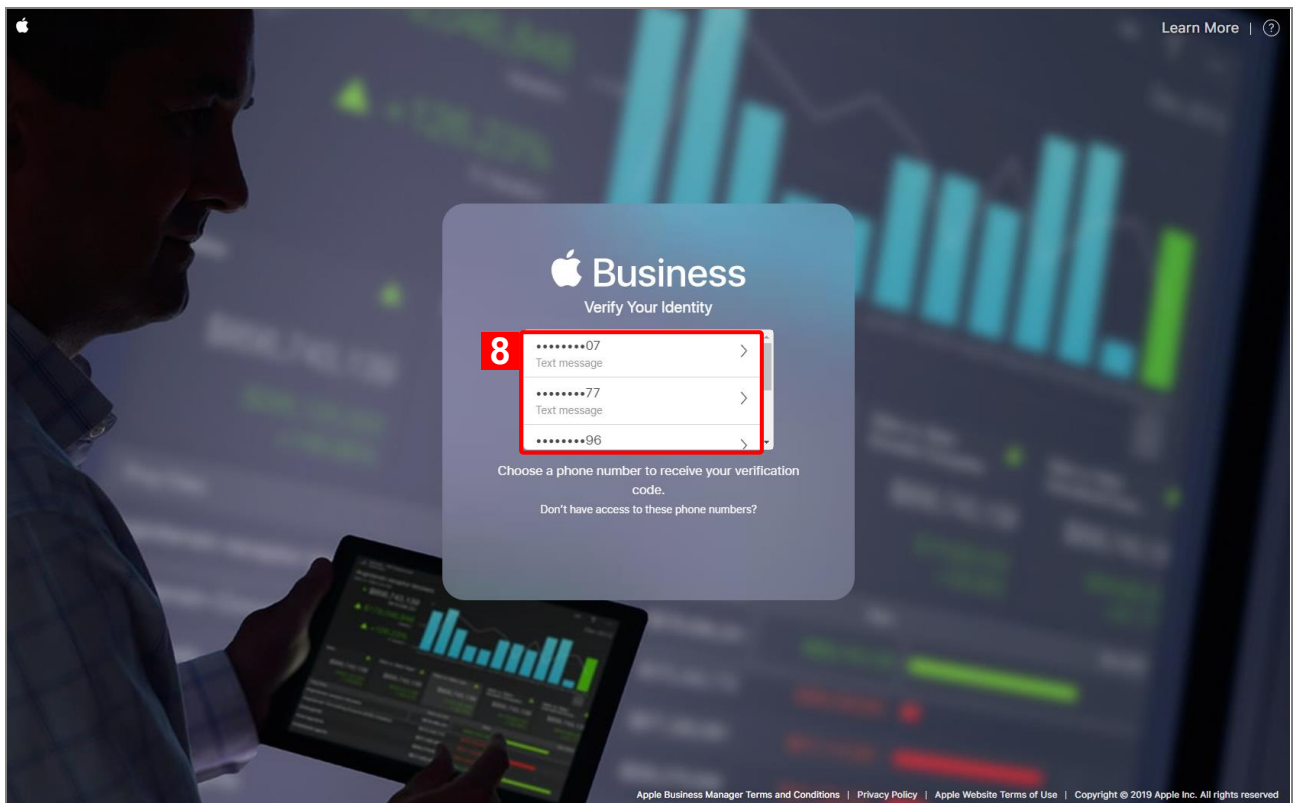

**[9] Confirm the destination selected in step [8] , then enter the confirmation code.**

⇒ Subsequent screen will be displayed automatically after you enter the 6-digits code.

✎ If the confirmation code is wrong, you cannot sign in and the screen in step [4] is displayed again.

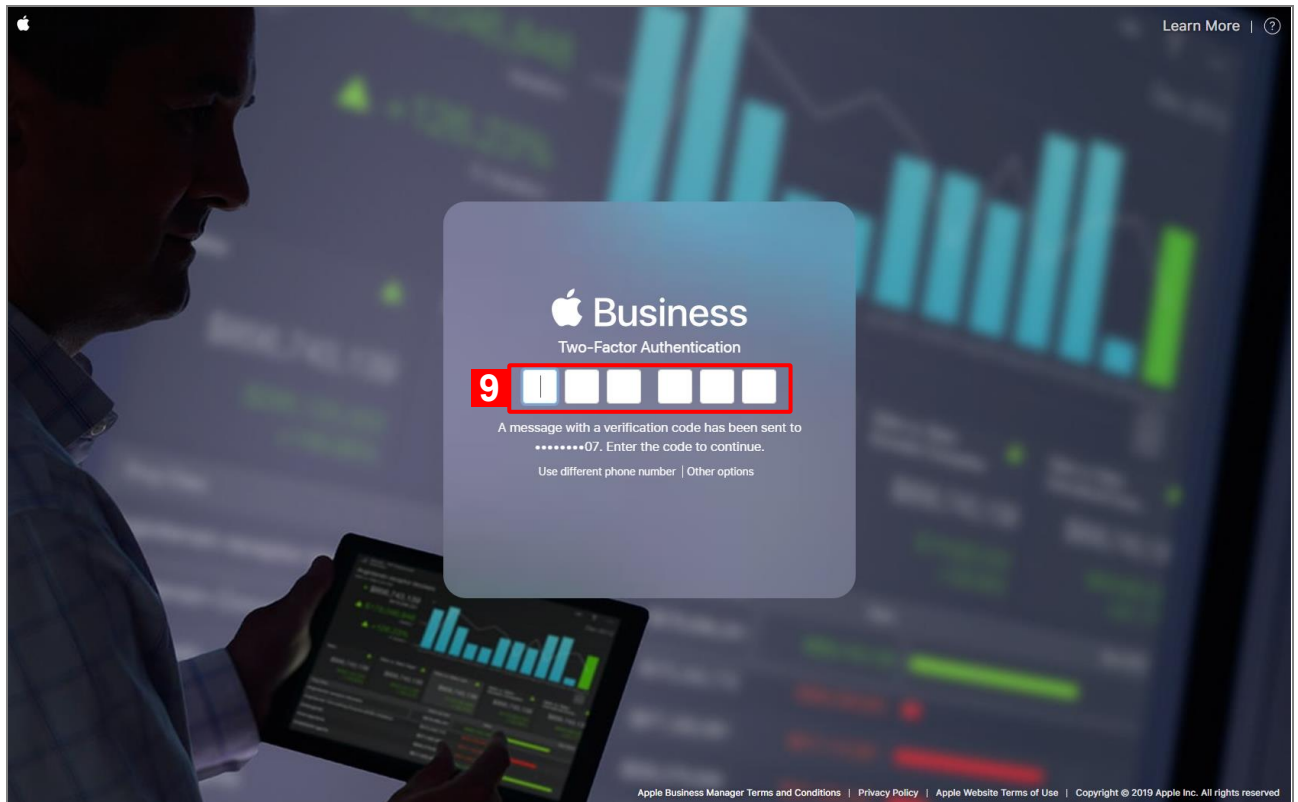

✎ The following screen may be displayed after the above operation. If you click [Trust] on the screen, you can sign in without entering the confirmation code from the next time when using the same browser on the same device. Make a favorable response in accordance with your use case.

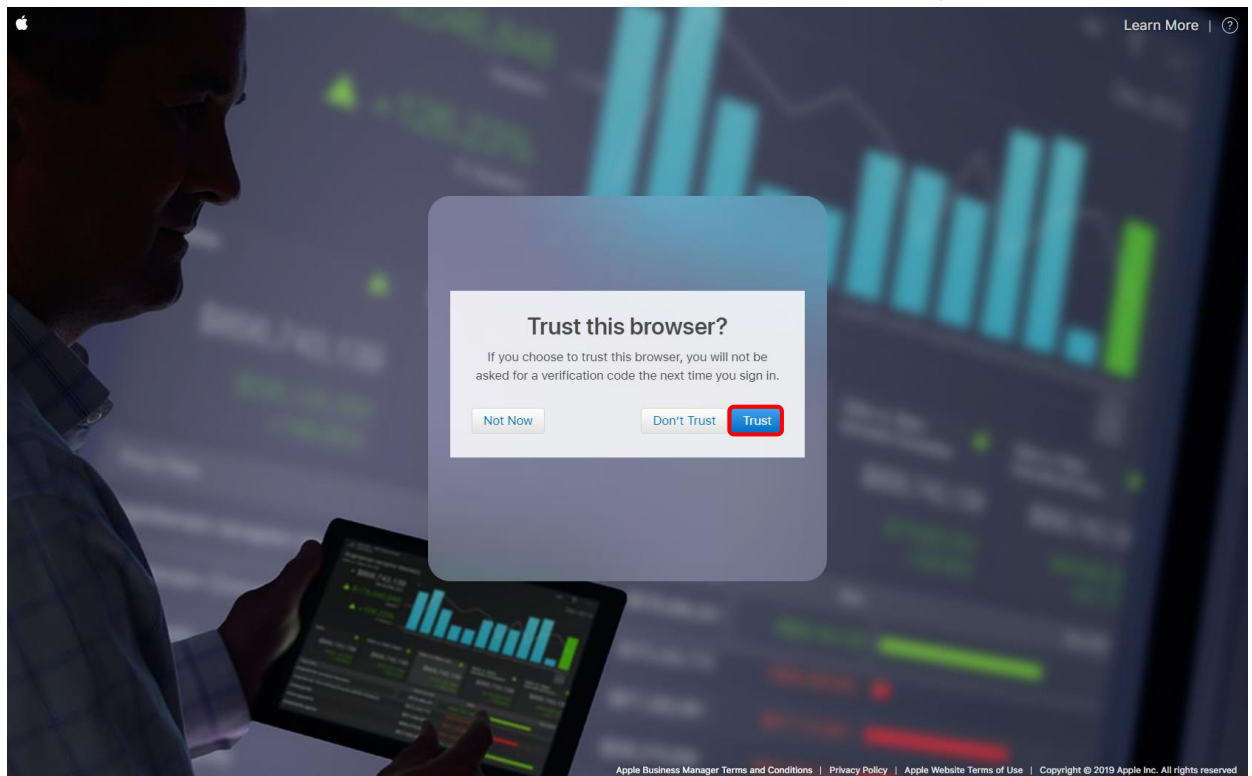

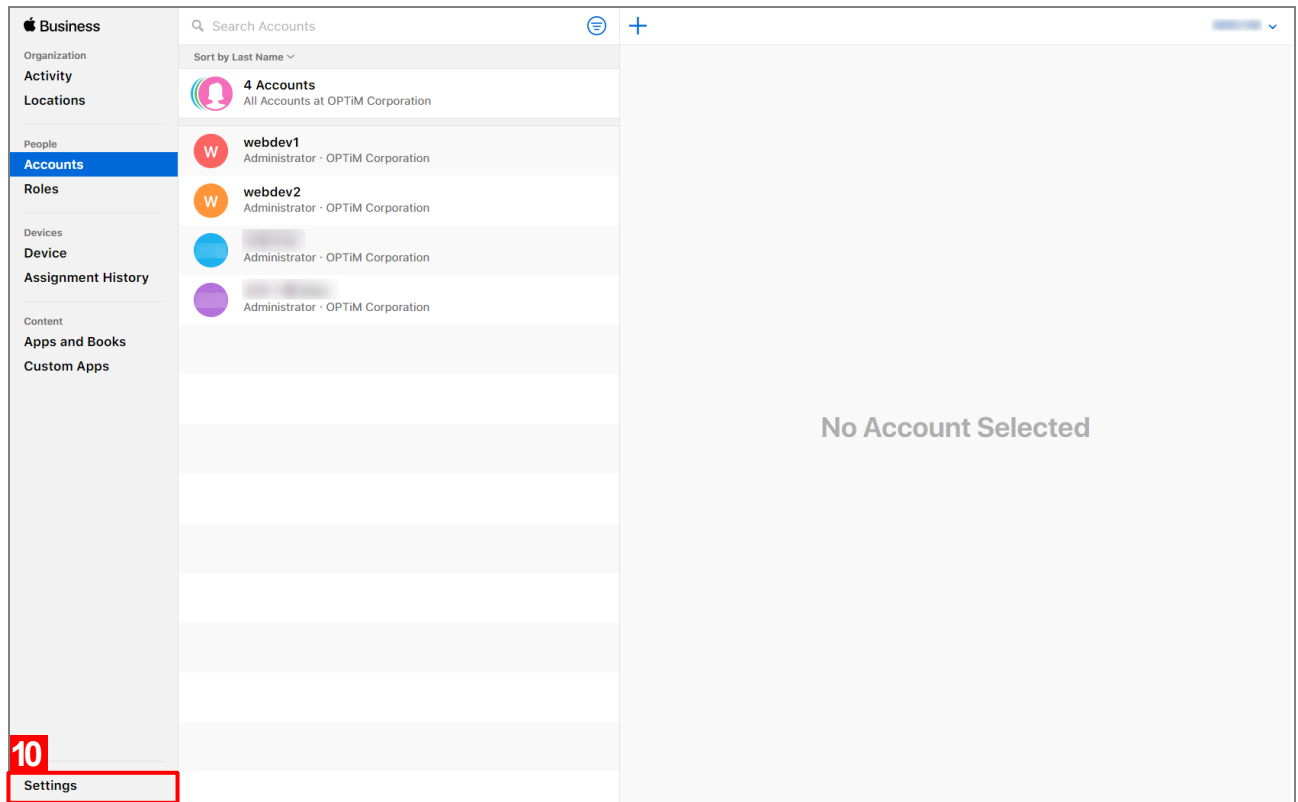
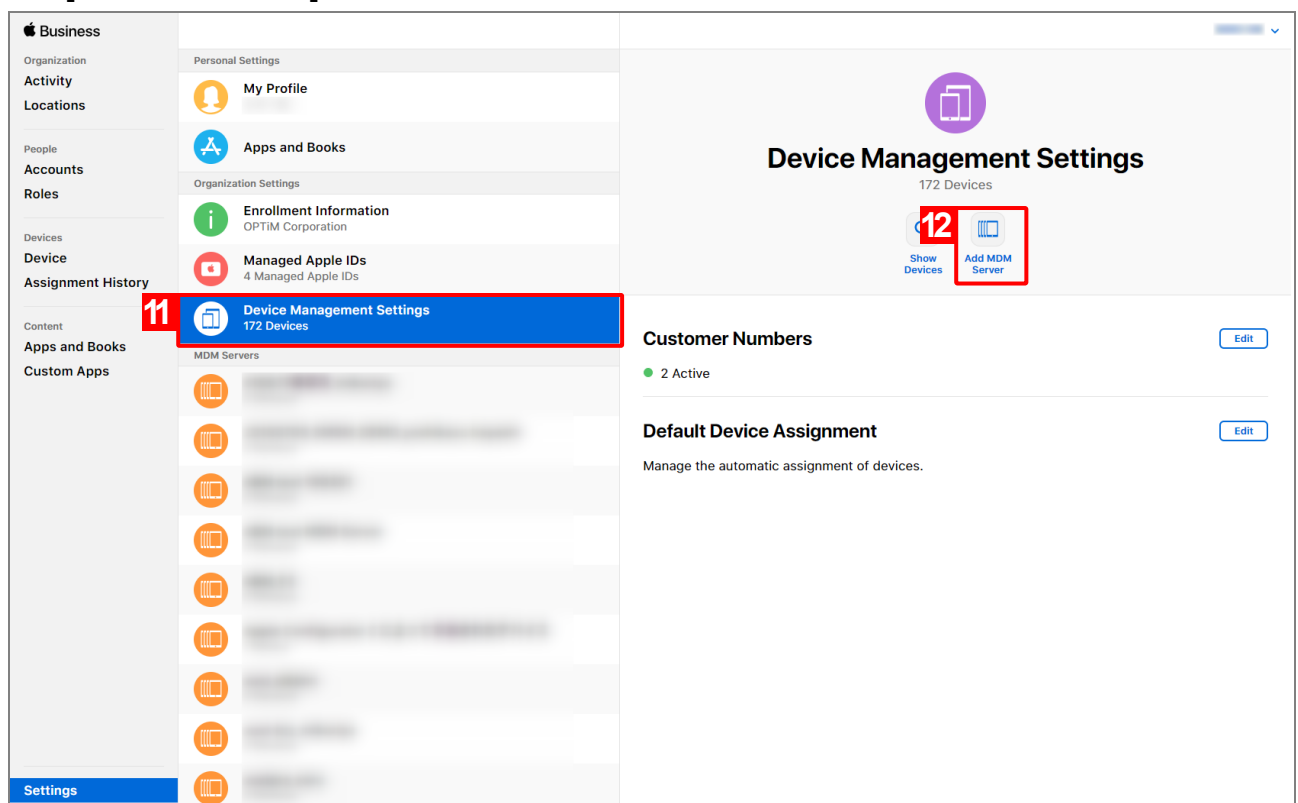
**[10] Click [Settings].****[11] Click [Device Management Settings].****[12] Click [Add MDM Server].**

**[13]** Enter "MDM Server Name" in "MDM Server Info".

**[14]** Upload the server public key (PEM) file downloaded from the management site by clicking [Choose File...].

**[15]** Click [Save].

✎ If you do not click [Save], the MDM server cannot communicate with the ABM server when certain period of time passes after the ADE token is registered. In this case, you need to reacquire the ADE token.

✎ Download the ADE token at the time of registering it. Communications with the MDM server may fail if a long period of time passes without uploading the ADE token to the management site after you download it.

The screenshot displays the Apple Business MDM Server configuration page. The sidebar on the left contains navigation links: Organization, Activity, Locations, People, Accounts, Roles, Devices, Device, Assignment History, Content, Apps and Books, and Custom Apps. The main content area is titled "Untitled MDM Server" and shows "0 Devices". It is divided into two sections: "MDM Server Info" and "MDM Server Settings". In the "MDM Server Info" section, the "MDM Server Name" field is highlighted with a red box and labeled with a red "13". In the "MDM Server Settings" section, the "Upload Public Key" field is highlighted with a red box and labeled with a red "14". At the bottom right, there are "Cancel" and "Save" buttons, with the "Save" button highlighted with a red box and labeled with a red "15".

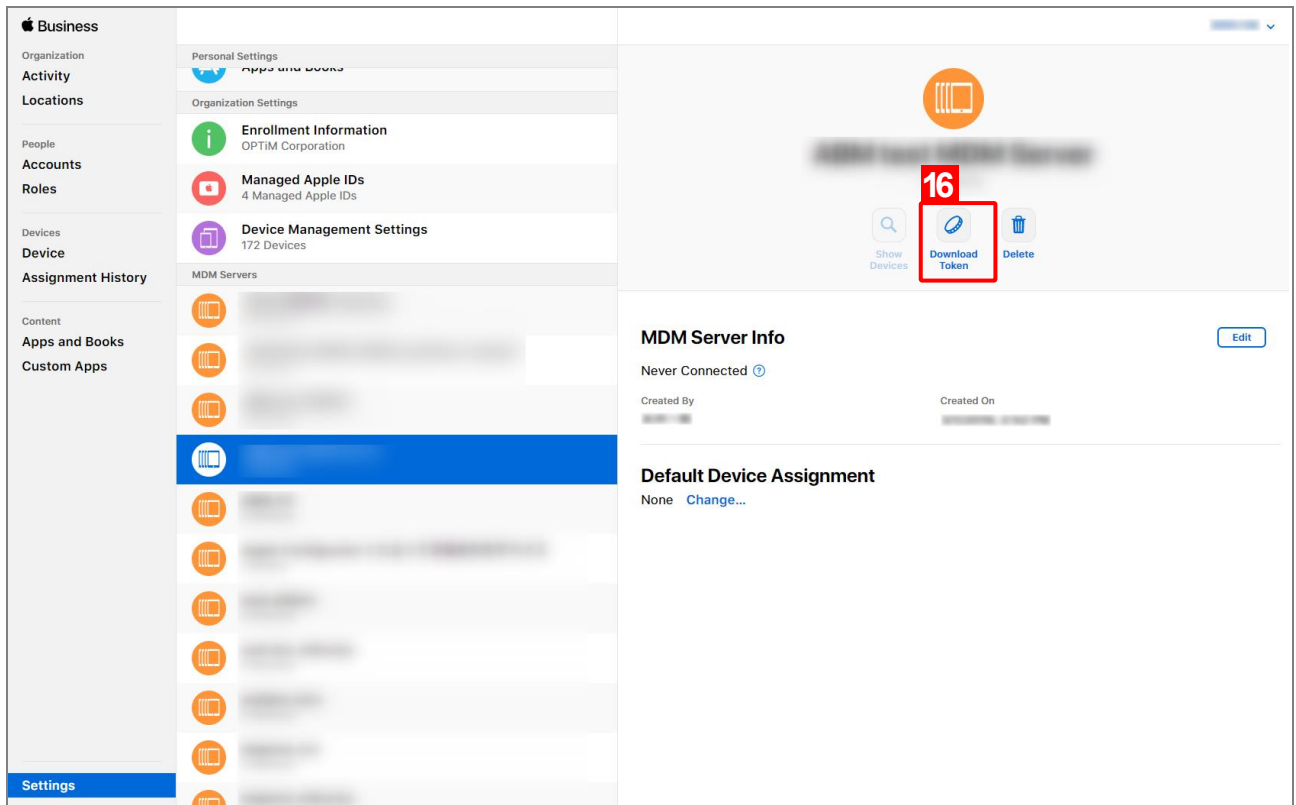
**[16] Click [Download Token].****[17] Click [Download Server Token].**

⇒ Downloading of the ADE token starts.

✍ Save the file to a location of your choice.

✂ The existing ADE token is reset. Download the ADE token when the need comes as communications may fail if a long period of time passes after you download it.

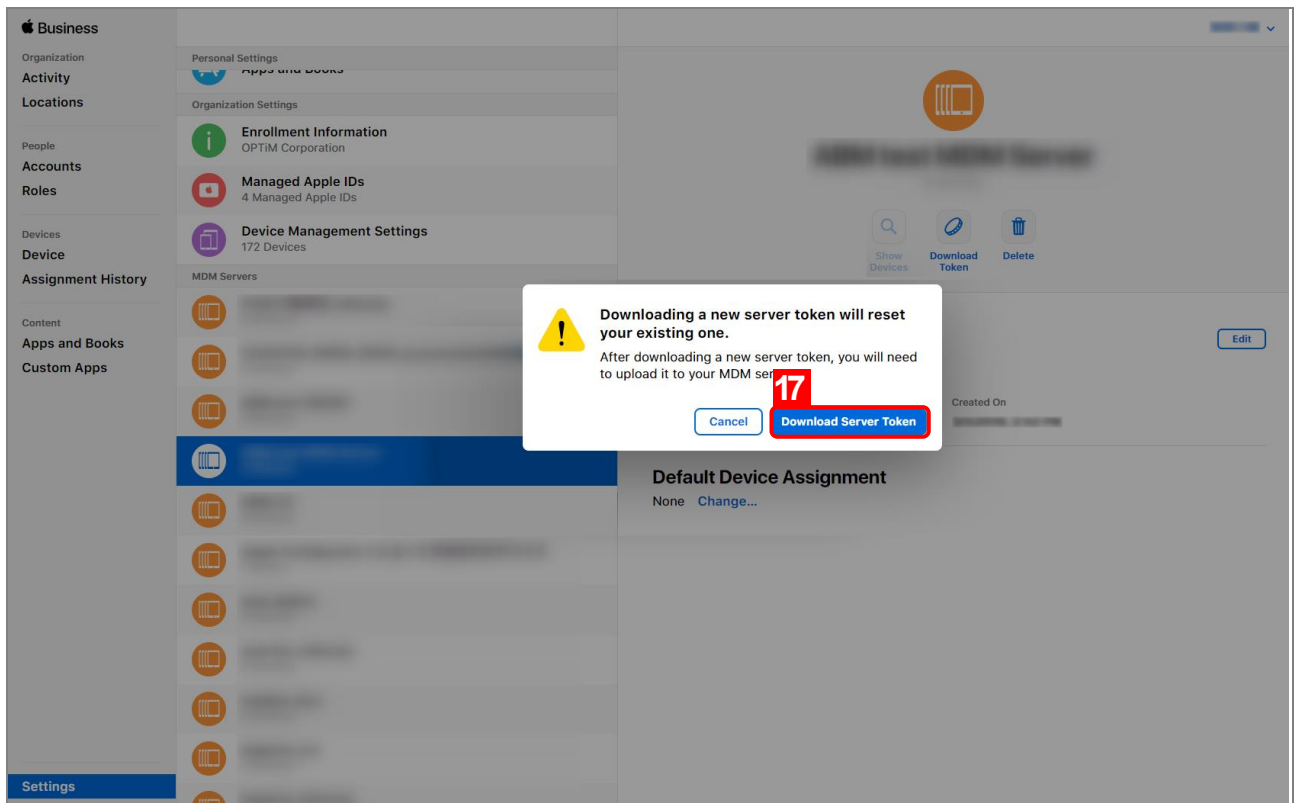

**[18] Click [Devices].**

**[19] Click the device to assign to the MDM server.**

 If your device is not displayed in the search result, or does not appear on the list, please contact Apple.

 The devices displayed on the list can be searched by (A).

**[20] Click [Edit Device Management].**

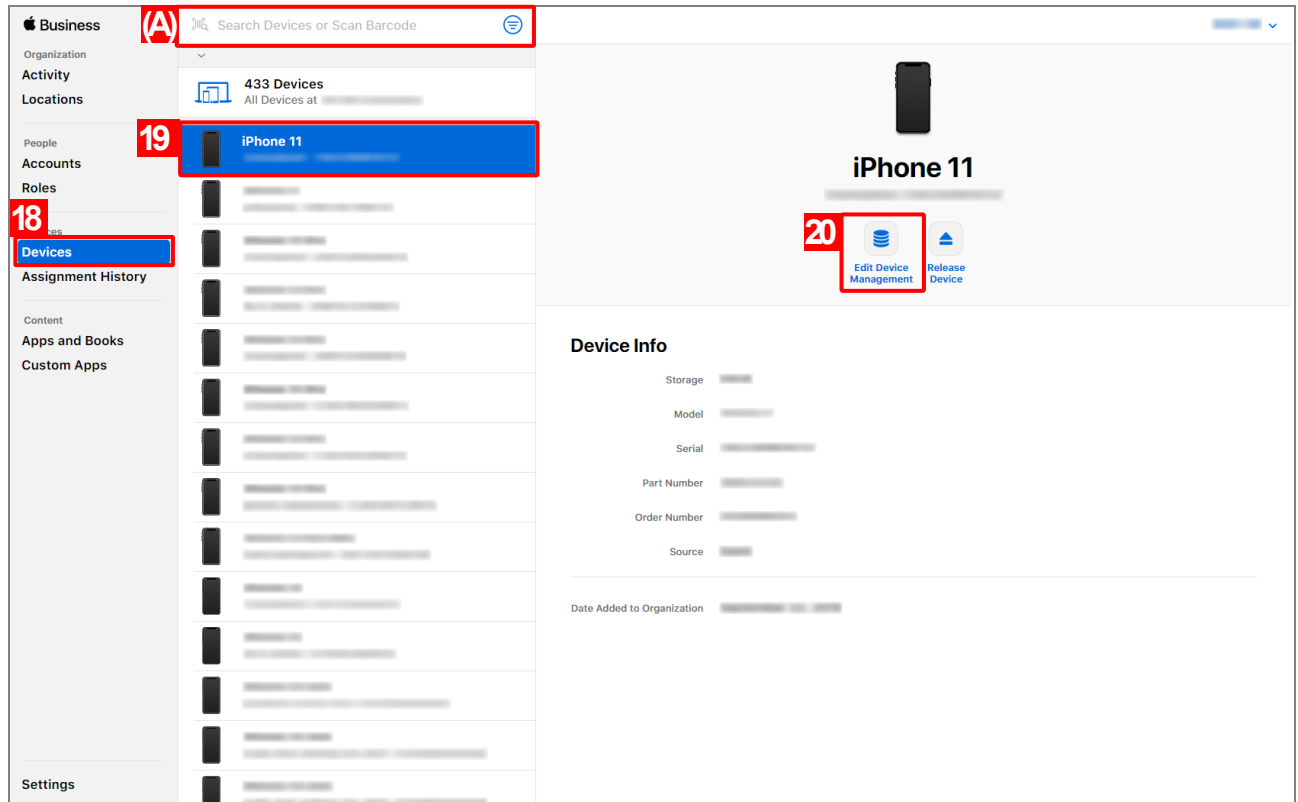

The screenshot shows the Apple Business Manager interface. On the left sidebar, the 'Devices' option is highlighted with a red box and labeled 18. Above it, the 'Search Devices or Scan Barcode' bar is highlighted with a red box and labeled (A). In the main content area, the '433 Devices' list is shown, with the first device, an 'iPhone 11', highlighted with a red box and labeled 19. To the right of the device list, the 'Device Info' section is visible, showing details like Storage, Model, Serial, Part Number, Order Number, Source, and Date Added to Organization. The 'Edit Device Management' button is highlighted with a red box and labeled 20.

**[21] Select the MDM server.**

☑ Select the MDM server that you created when you obtained the ADE token.

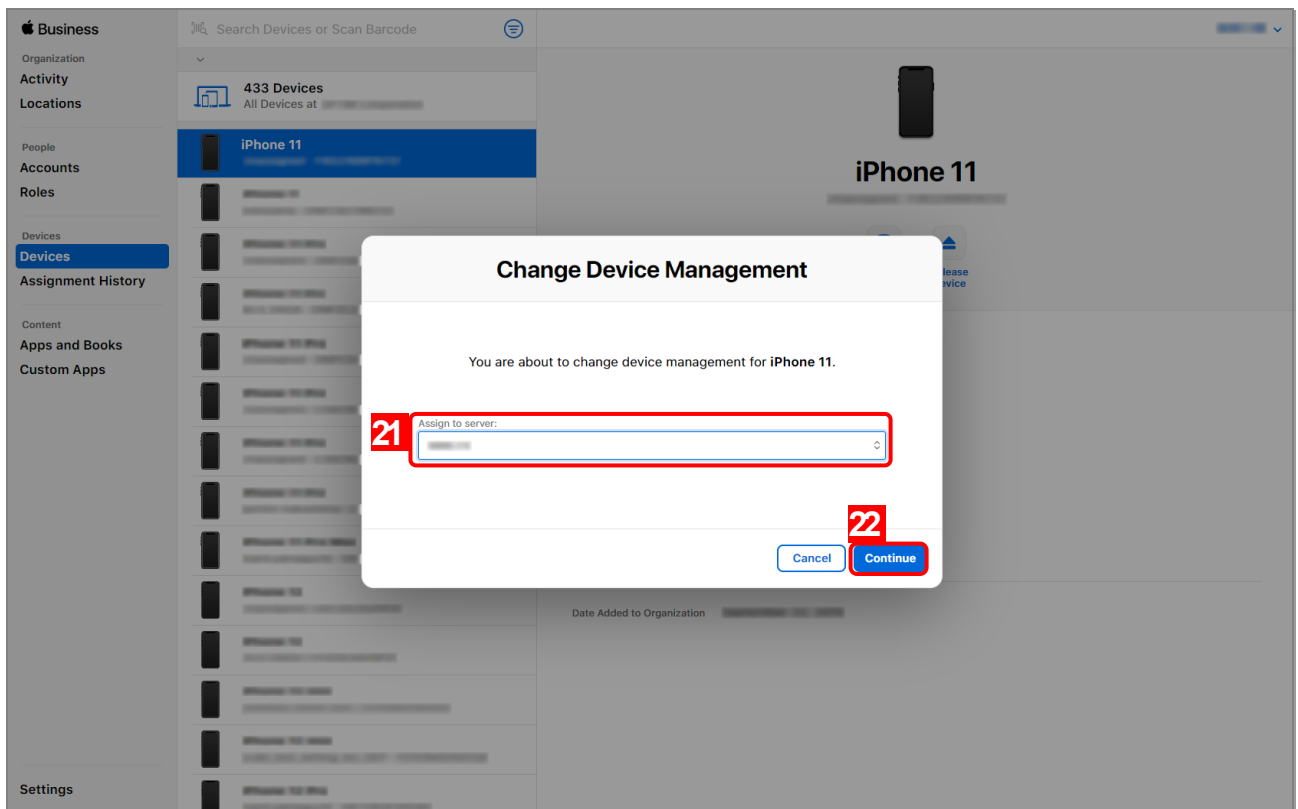
**[22] Click [Continue].****[23] Click [Continue].**

⇒ The target device will be assigned to the MDM server.

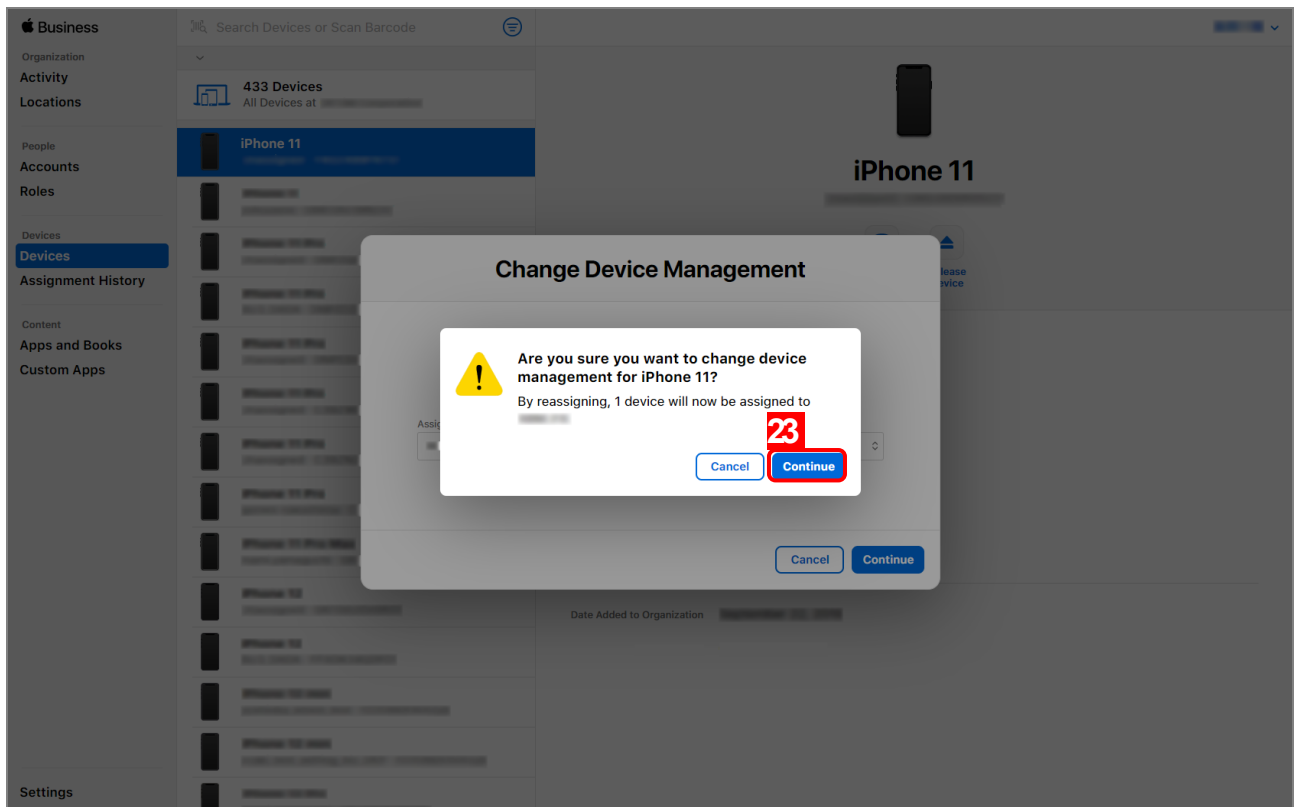



**[24] Click [Done].**

☞ If you have more than one device to assign, repeat steps [19] to [24].

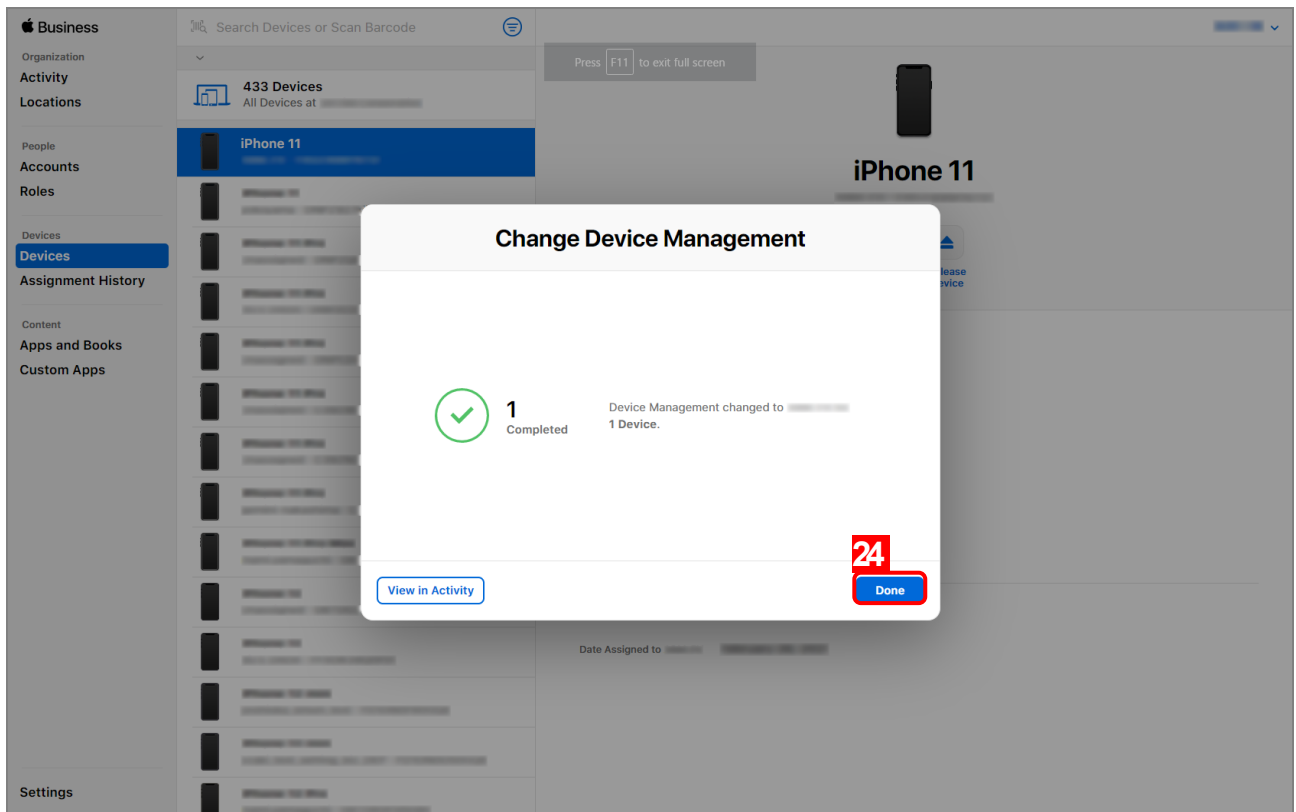

## 2.1.3 Registering ADE token

**[25] Click [Choose file].**

⇒ Select the ADE token downloaded in step [17].

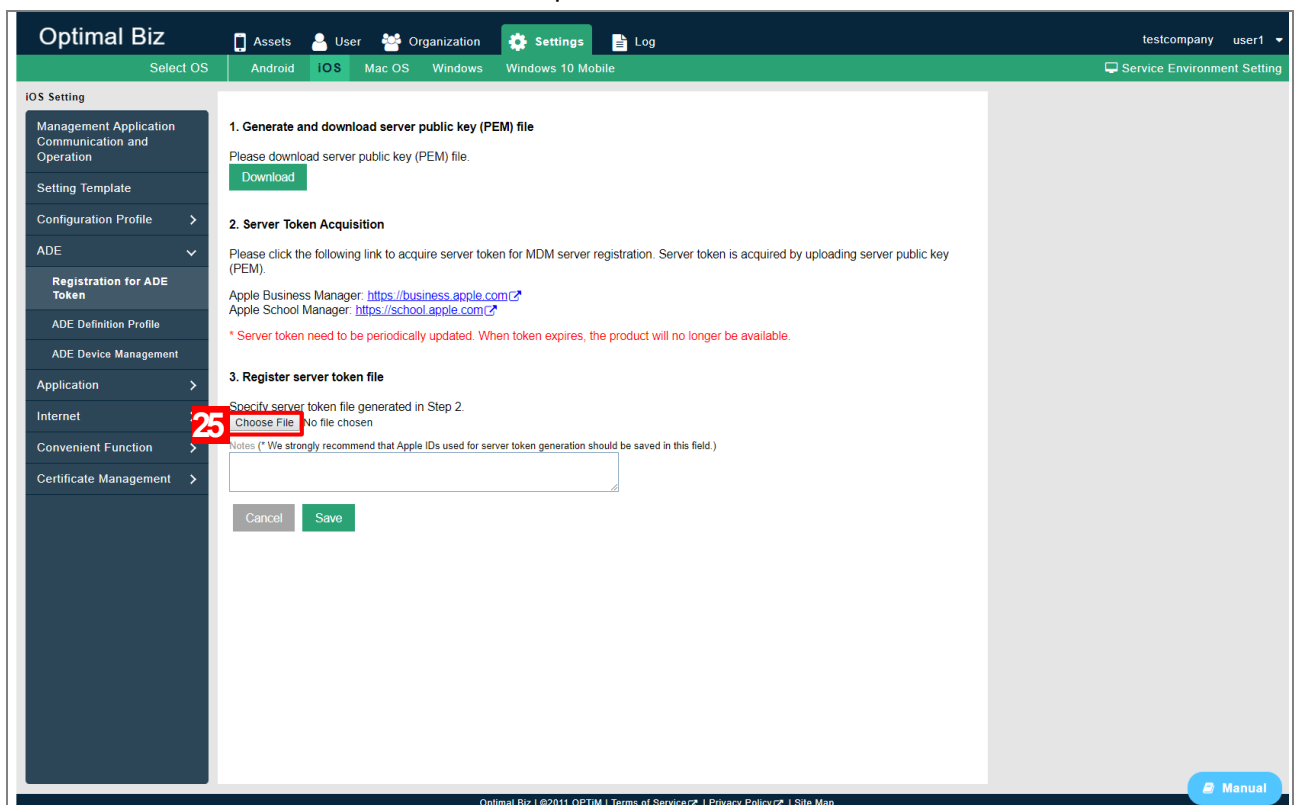



**[26]** Confirm that the name of the selected file is displayed on the right side of [Choose file].

**[27]** Enter "Notes".

-  We recommend entering the Apple ID that you used when acquiring the ADE token and the acquisition date of it in "Notes" for reference when you update it.

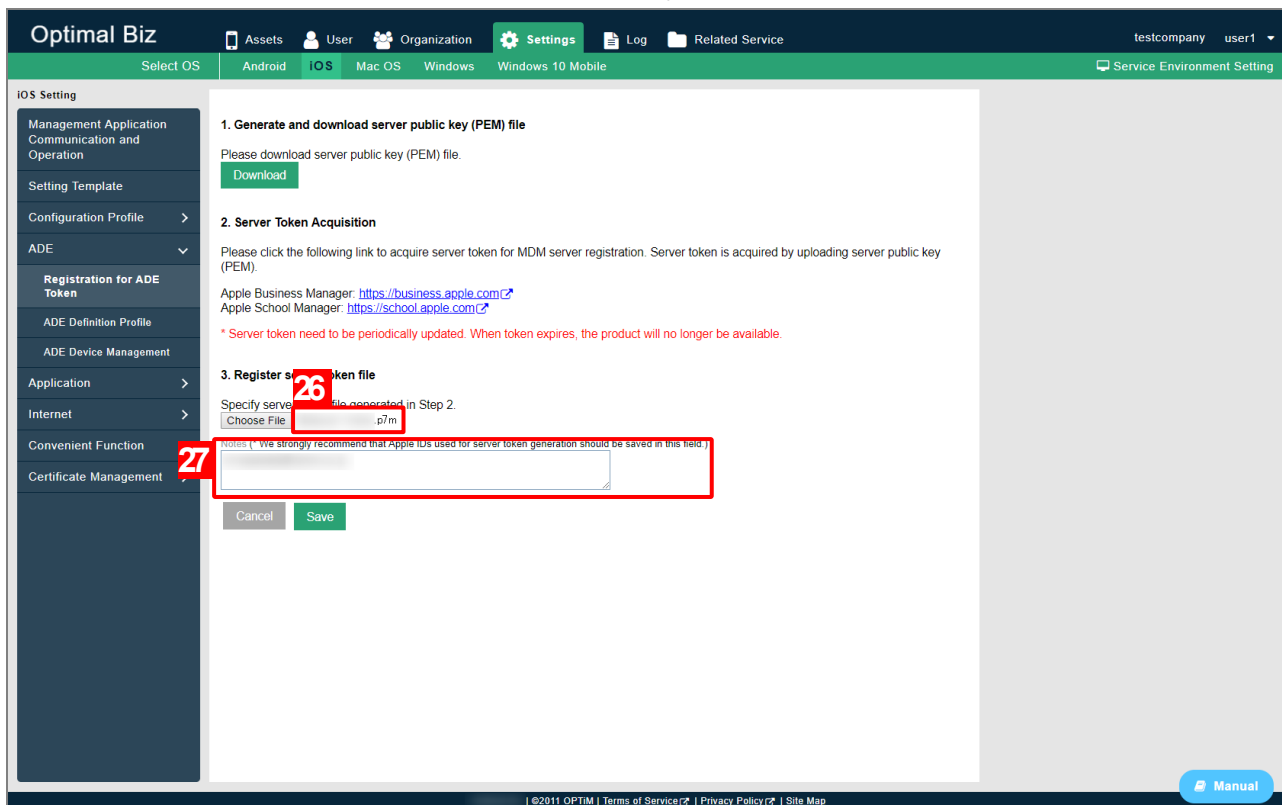

Optimal Biz

Assets User Organization Settings Log Related Service testcompany user1

Select OS Android iOS Mac OS Windows Windows 10 Mobile Service Environment Setting

IOS Setting

Management Application Communication and Operation

Setting Template

Configuration Profile >

ADE >

Registration for ADE Token

ADE Definition Profile

ADE Device Management

Application >

Internet >

Convenient Function >

Certificate Management >

1. Generate and download server public key (PEM) file

Please download server public key (PEM) file.

Download

2. Server Token Acquisition

Please click the following link to acquire server token for MDM server registration. Server token is acquired by uploading server public key (PEM).

Apple Business Manager: <https://business.apple.com/>

Apple School Manager: <https://school.apple.com/>

\* Server token need to be periodically updated. When token expires, the product will no longer be available.

3. Register server token file

Specify server token file generated in Step 2.

Choose File p7m

Notes (\* We strongly recommend that Apple IDs used for server token generation should be saved in this field.)

Cancel Save

Manual

©2011 OPTIM | Terms of Service | Privacy Policy | Site Map

**[28]** Click [Save].

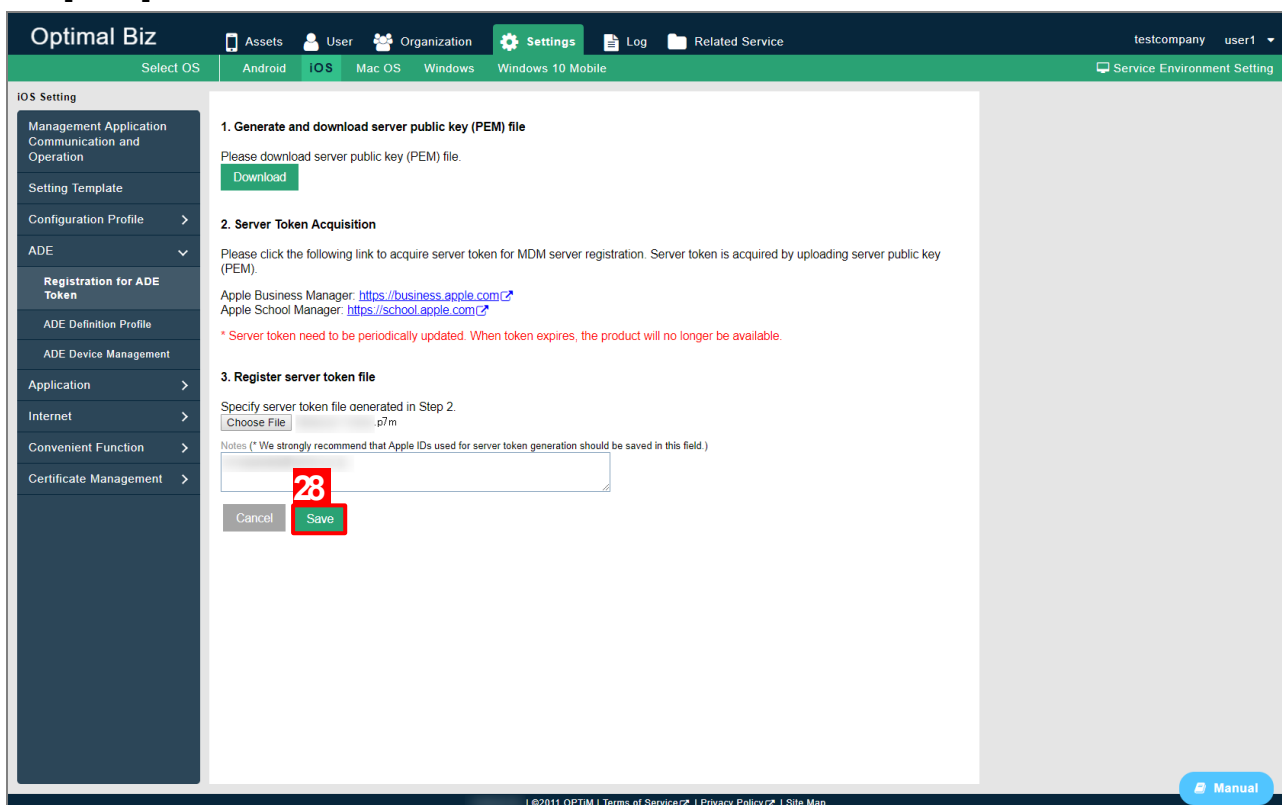

Optimal Biz

Assets User Organization Settings Log Related Service testcompany user1

Select OS Android iOS Mac OS Windows Windows 10 Mobile Service Environment Setting

IOS Setting

Management Application Communication and Operation

Setting Template

Configuration Profile >

ADE >

Registration for ADE Token

ADE Definition Profile

ADE Device Management

Application >

Internet >

Convenient Function >

Certificate Management >

1. Generate and download server public key (PEM) file

Please download server public key (PEM) file.

Download

2. Server Token Acquisition

Please click the following link to acquire server token for MDM server registration. Server token is acquired by uploading server public key (PEM).

Apple Business Manager: <https://business.apple.com/>

Apple School Manager: <https://school.apple.com/>

\* Server token need to be periodically updated. When token expires, the product will no longer be available.

3. Register server token file

Specify server token file generated in Step 2.

Choose File p7m

Notes (\* We strongly recommend that Apple IDs used for server token generation should be saved in this field.)

Cancel Save

Manual

©2011 OPTIM | Terms of Service | Privacy Policy | Site Map

**[29] [Registered server token.] is displayed.**

⇒ Confirm (A) the validity period of "Server Token".

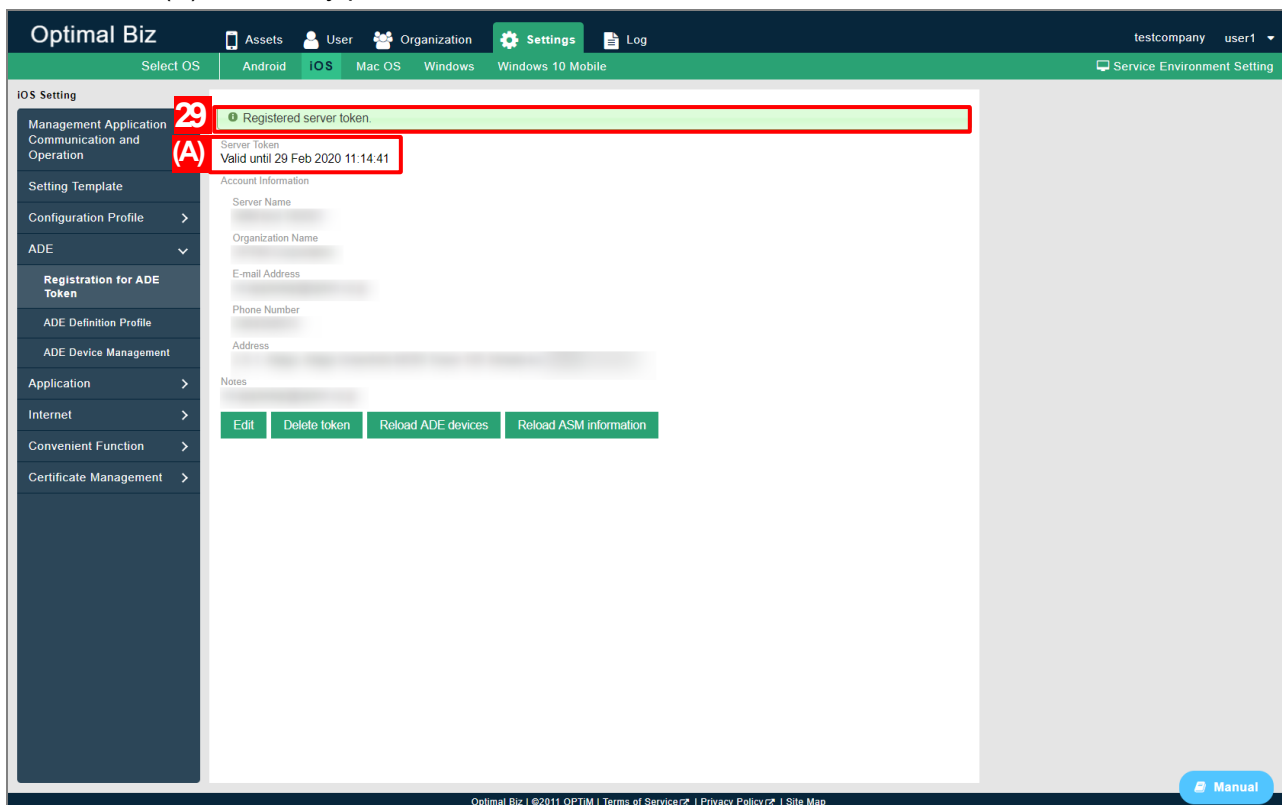

- ☑ The ADE device information is reloaded by clicking [Reload ADE devices]. Then, all ADE license information such as token information and the number of currently allocated devices are updated. Note that the reload processing causes increasing communication load.
- ☑ [Sync with ADE service] in [ADE Device Management] is usually used for the update of the license information. However, there may be errors between the ADE license settings and the actual license allocation status as this function only acquires the information that has been changed since the last time. In this case, update the ADE device information using [Reload ADE devices].
- ✎ Click [Edit] to edit the account.
- ✎ Click [Delete token] to delete the token.

## 2.2 Updating ADE token

---

You need to update the ADE token within one year before it expires. For details, refer to the following.

 <ABM Server Token Annual Update Manual>

## 2.3 Device management

---

For details on how to apply settings to devices managed by ADE and how to create ADE definition profile, refer to the following.

 "ADE Device Management" in <Automated Device Enrollment (ADE) Operation Manual>.

---

## 3 Using "Contents – Apps and Books"

Describes the following items.

Item	Page
<a href="#">Usage flow of "Contents – Apps and Books"</a>	<a href="#">21</a>
<a href="#">Updating Apps and Books Location Token</a>	<a href="#">28</a>
<a href="#">Procedure to deliver application/book</a>	<a href="#">28</a>

### 3.1 Usage flow of "Contents – Apps and Books"

Use "Contents – Apps and Books" of ABM with the following flow.

Item	Page
<a href="#">Acquiring the</a>	<a href="#">21</a>
<a href="#">Registering the</a>	<a href="#">25</a>

#### 3.1.1 Acquiring the Apps and Books Location Token

In order to distribute applications purchased from the Apps and Books store using Optimal Biz, it is necessary to link the Apps and Books with the Optimal Biz server. The Apps and Books Location Token is used for this link.

**[1]** Enter "Apple ID" for administrator.

**[2]** Click .

⇒ A screen for confirming the identity is displayed.

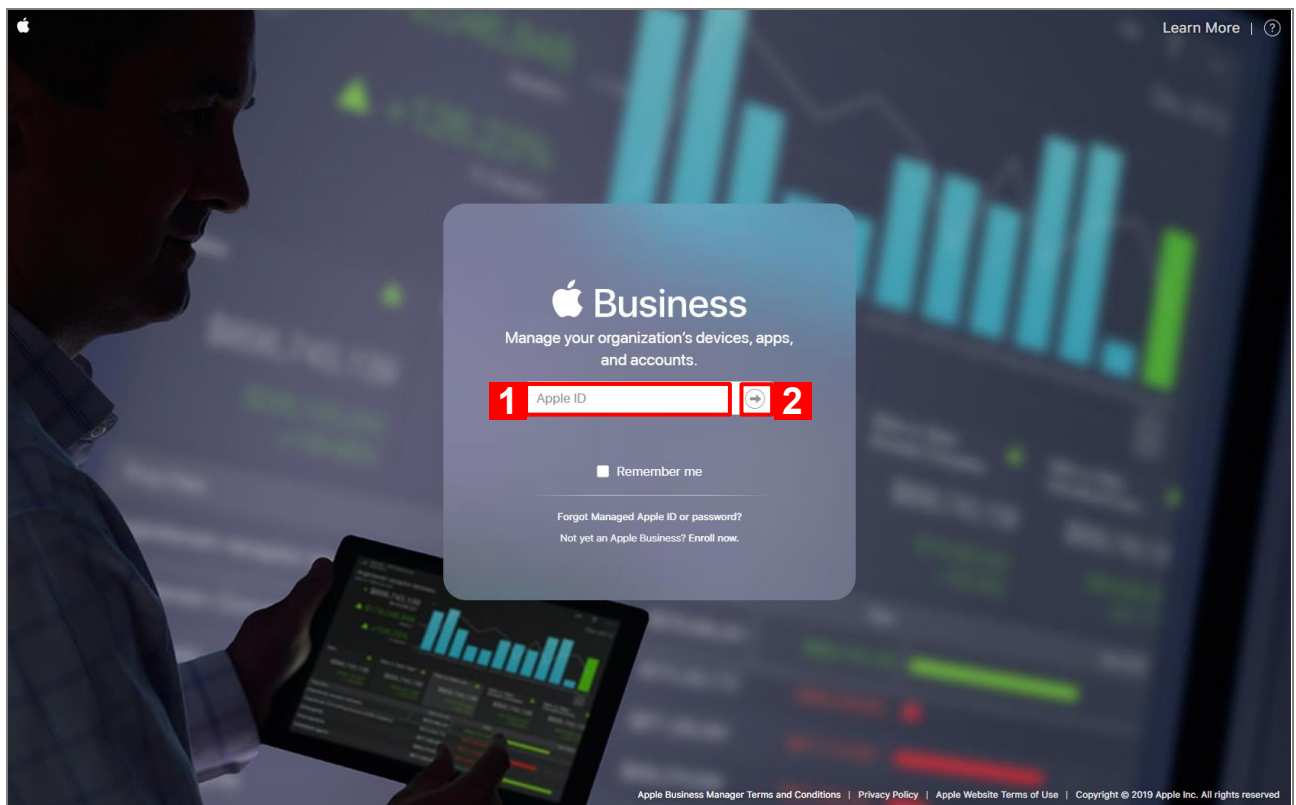

**[3]** As the password field appears, enter the password in it.

**[4]** Click .

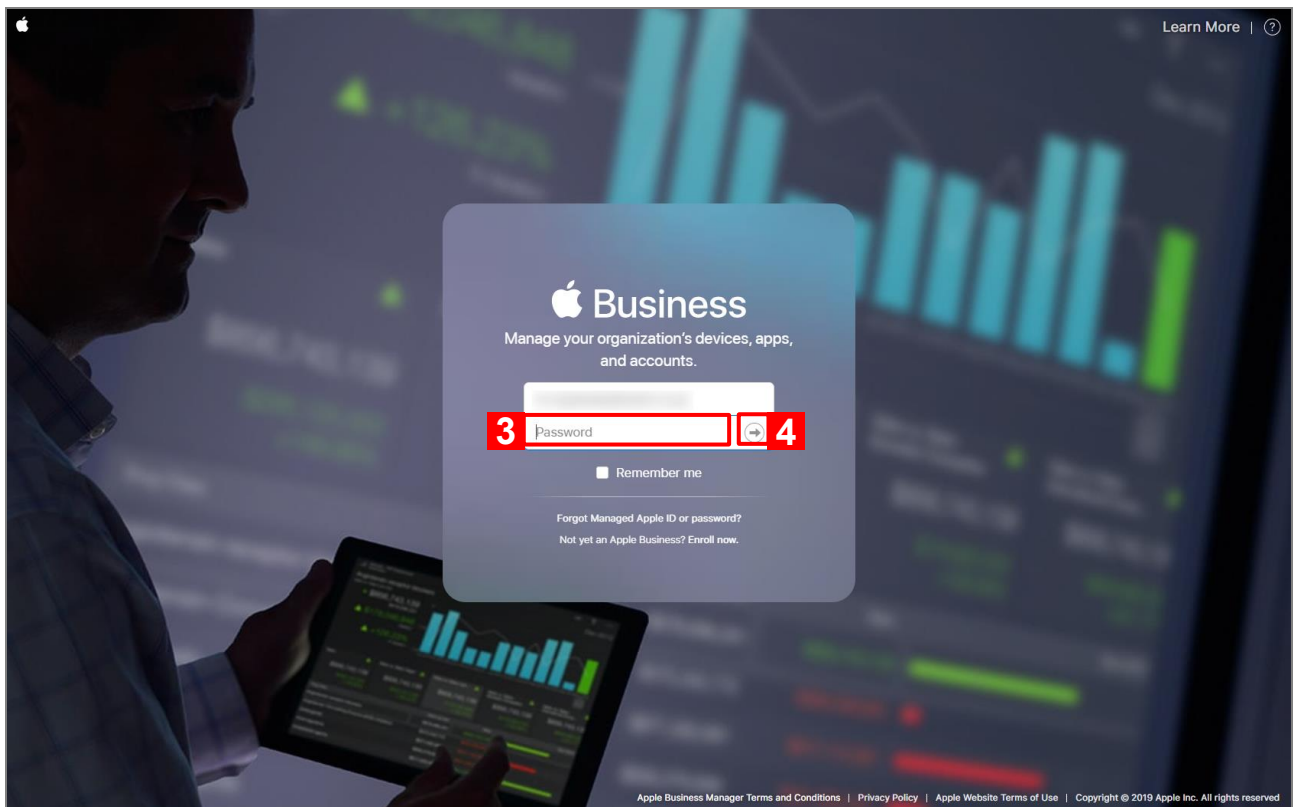

**[5]** Select a destination to which the confirmation code is sent.

⇒ The confirmation code will be sent to the selected destination.

☑ Choices are displayed when multiple destinations are registered.

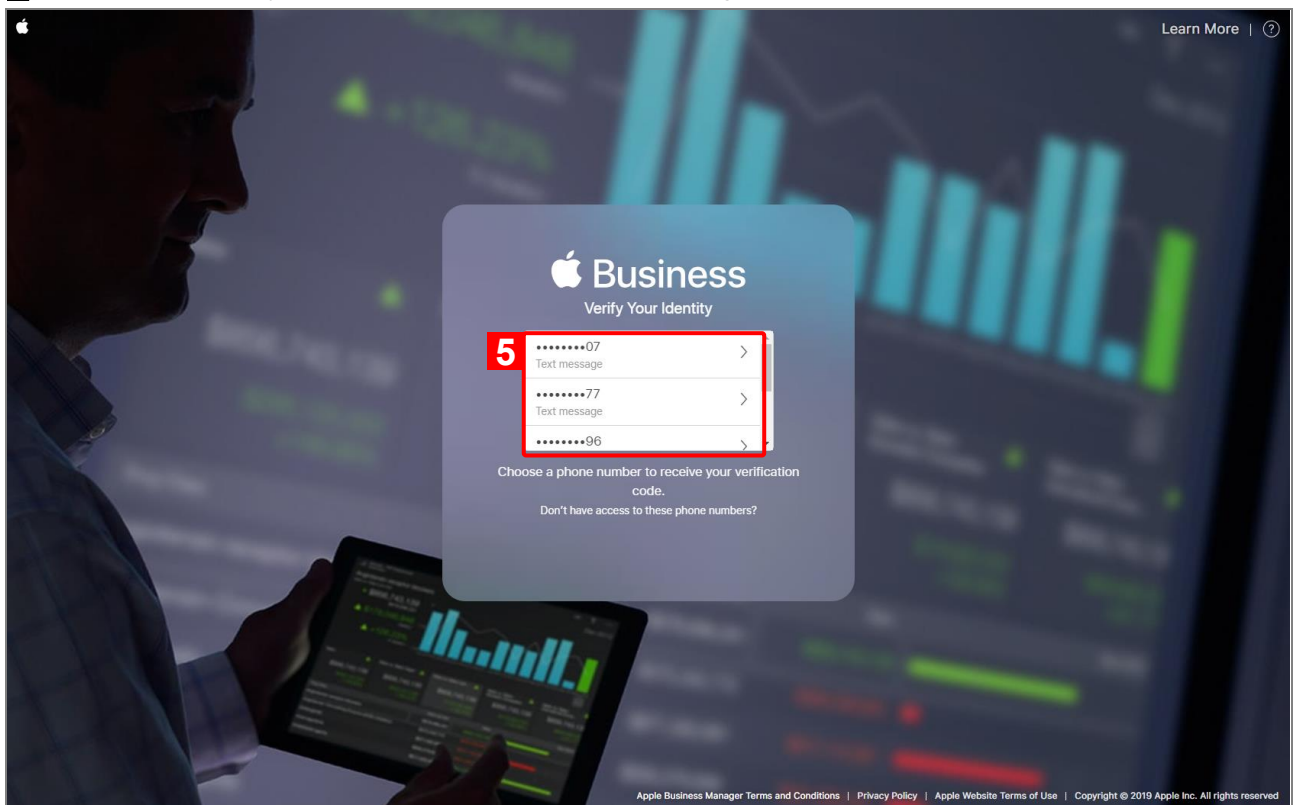

**[6] Confirm the destination selected in step [5] , then enter the confirmation code.**

⇒ Subsequent screen will be displayed automatically after you enter the 6-digits code.

✎ If the confirmation code is wrong, you cannot sign in and the screen in step [1] is displayed again.

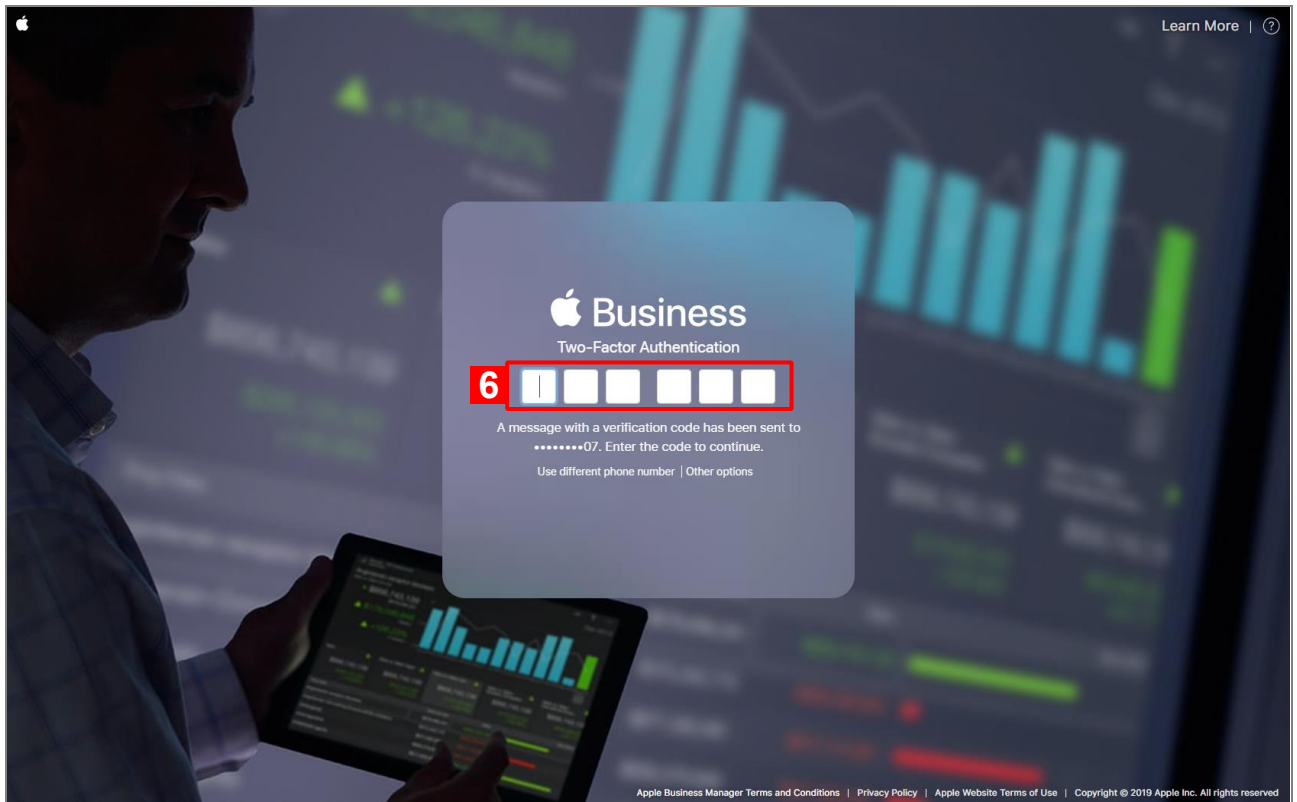

✎ The following screen may be displayed after the above operation. If you click [Trust] on the screen, you can sign in without entering the confirmation code from the next time when using the same browser on the same device. Make a favorable response in accordance with your use case.

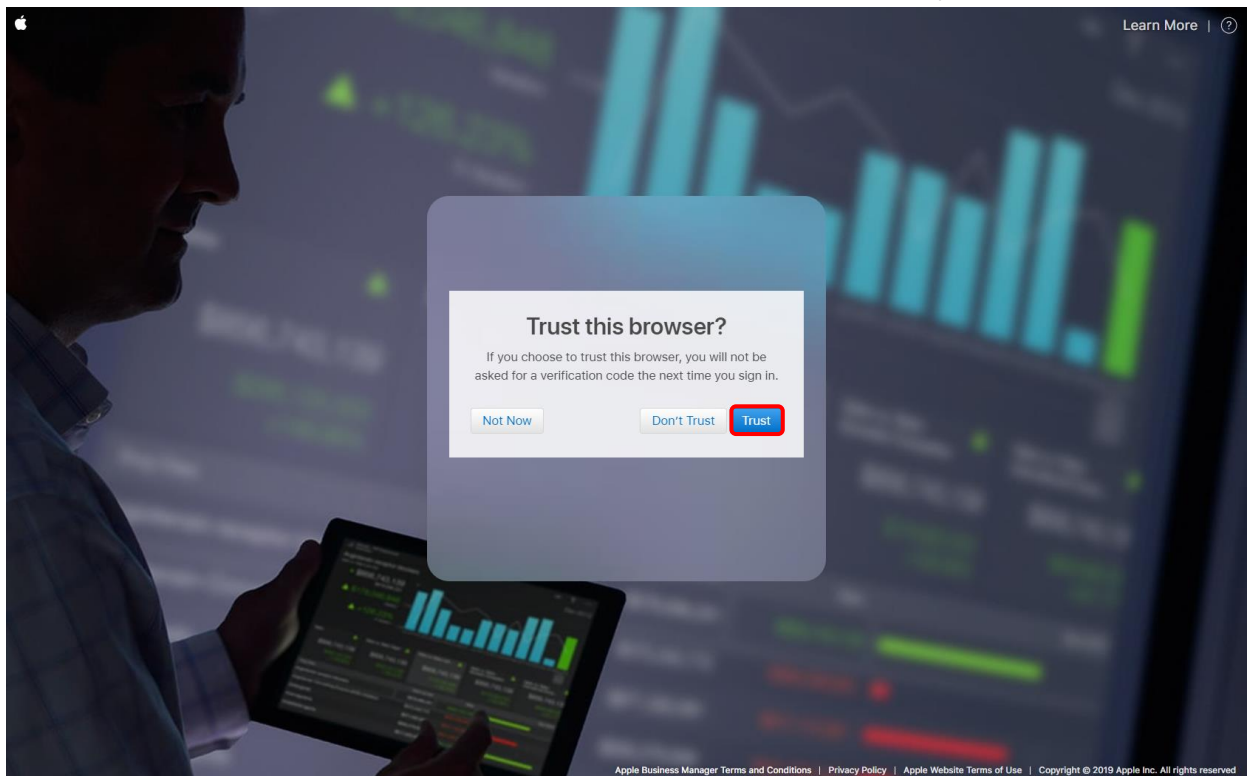

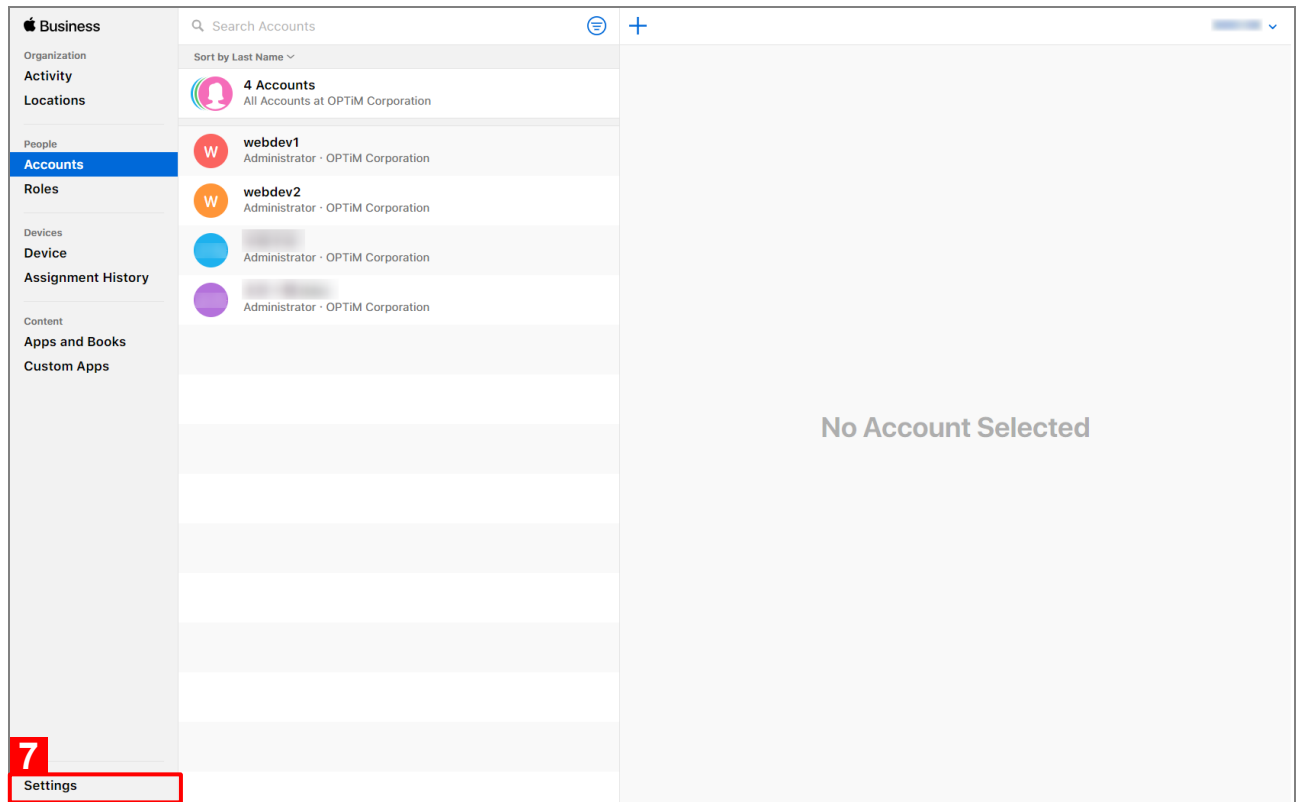
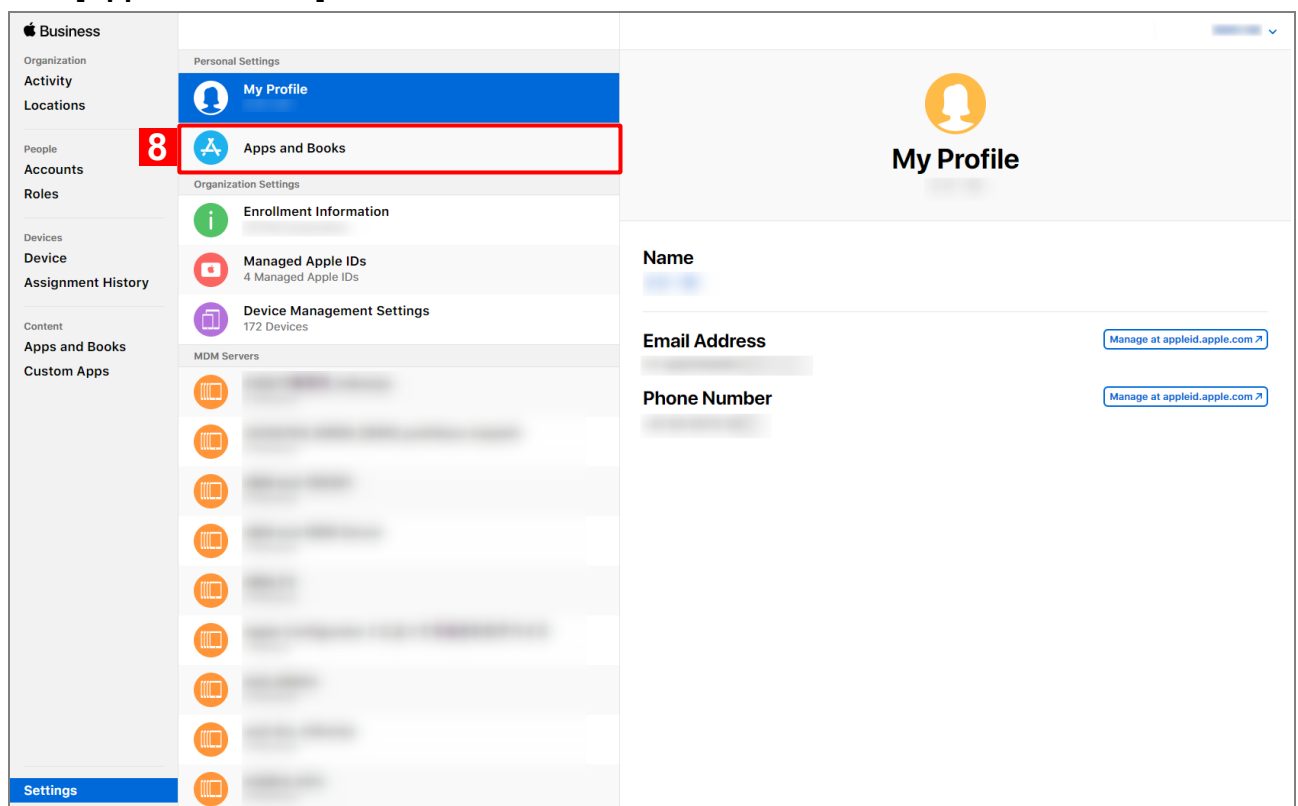
**[7] Click [Settings].****[8] Click [Apps and Books].**



**[9] Click [Download] of the correspond token displayed in "My Server Tokens".**

⇒ Downloading of the Apps and Books Location Token starts.

✎ Save the file to a location of your choice.

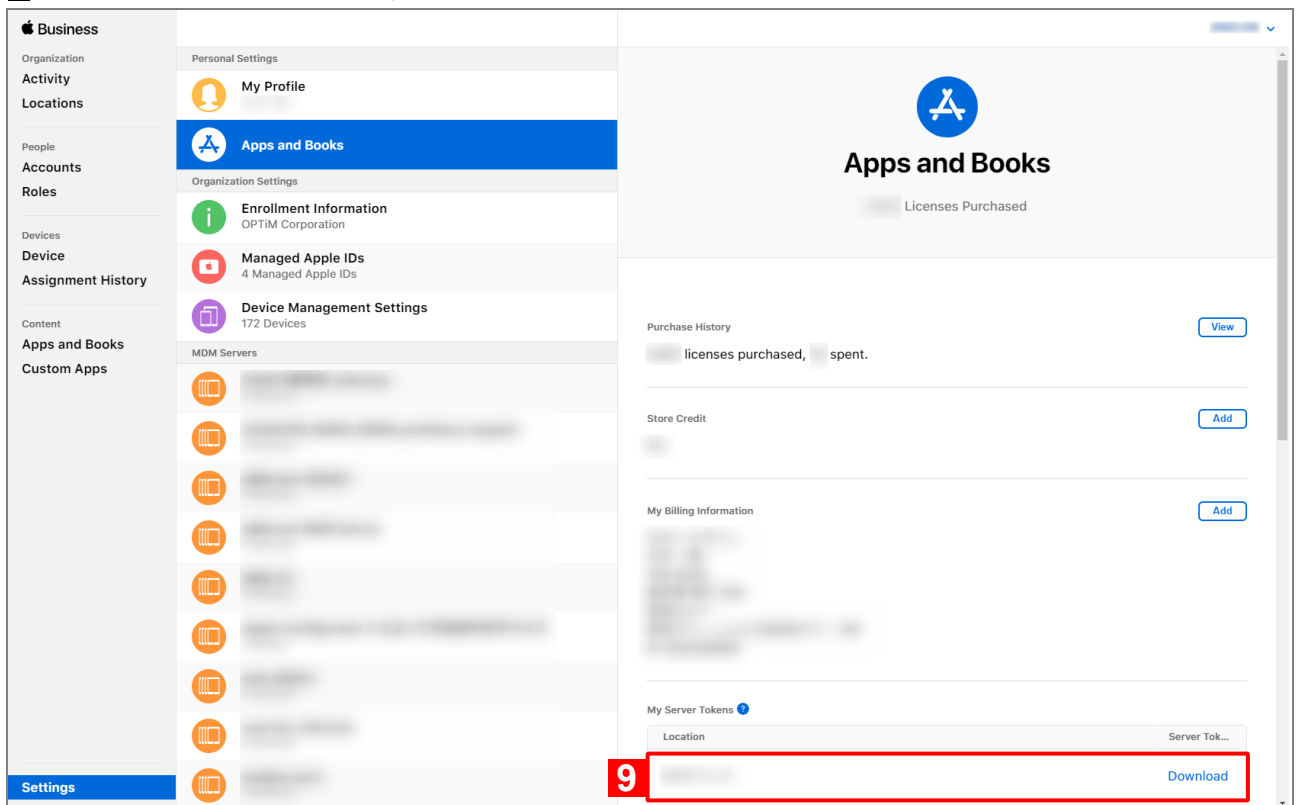

### 3.1.2 Registering the Apps and Books Location Token

**[10] Click [Settings]→[iOS]→[Application]→[Apps and Books License]→+.**

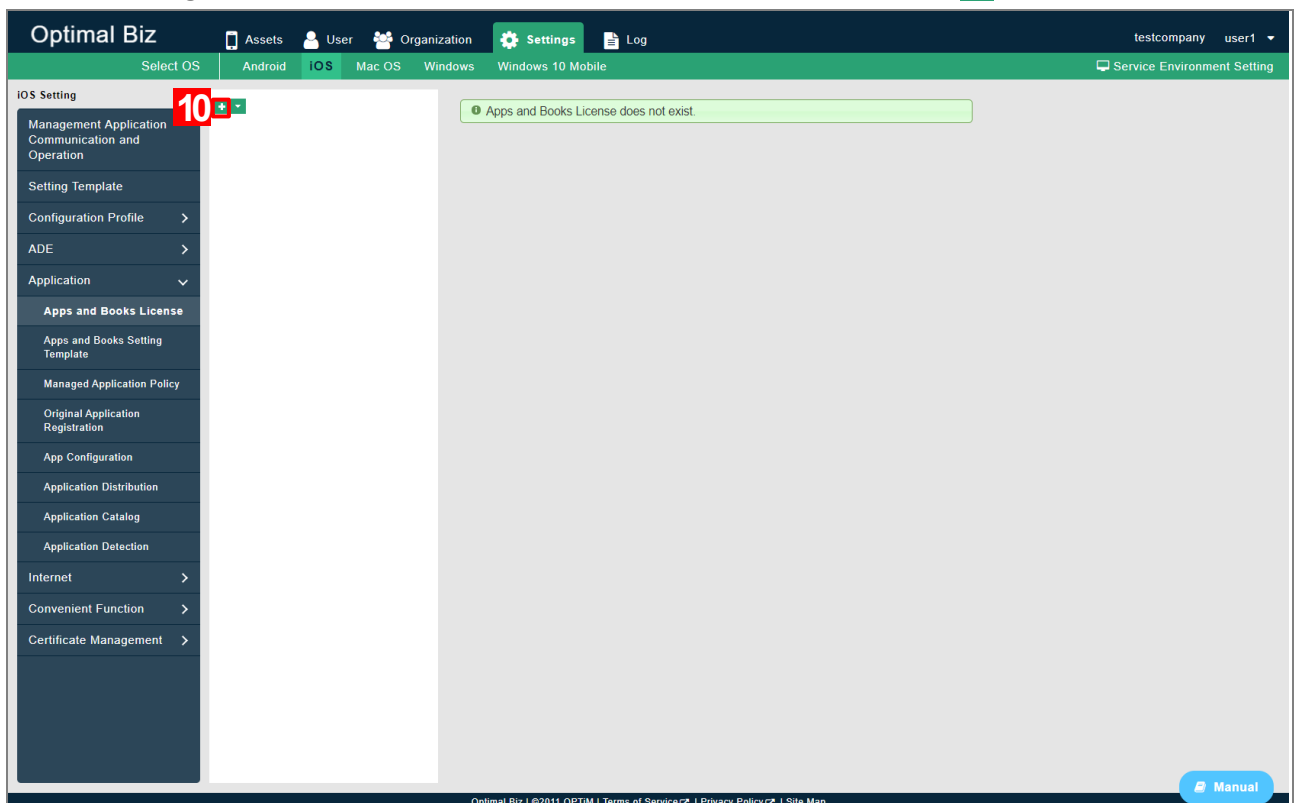

**[11] Click [Choose file] in " Apps and Books Location Token Upload".**

⇒ Select the Apps and Books Location Token downloaded from "Apps and Books" in step [9] .

✎ The description of "Choose file" may vary depending on the browser.

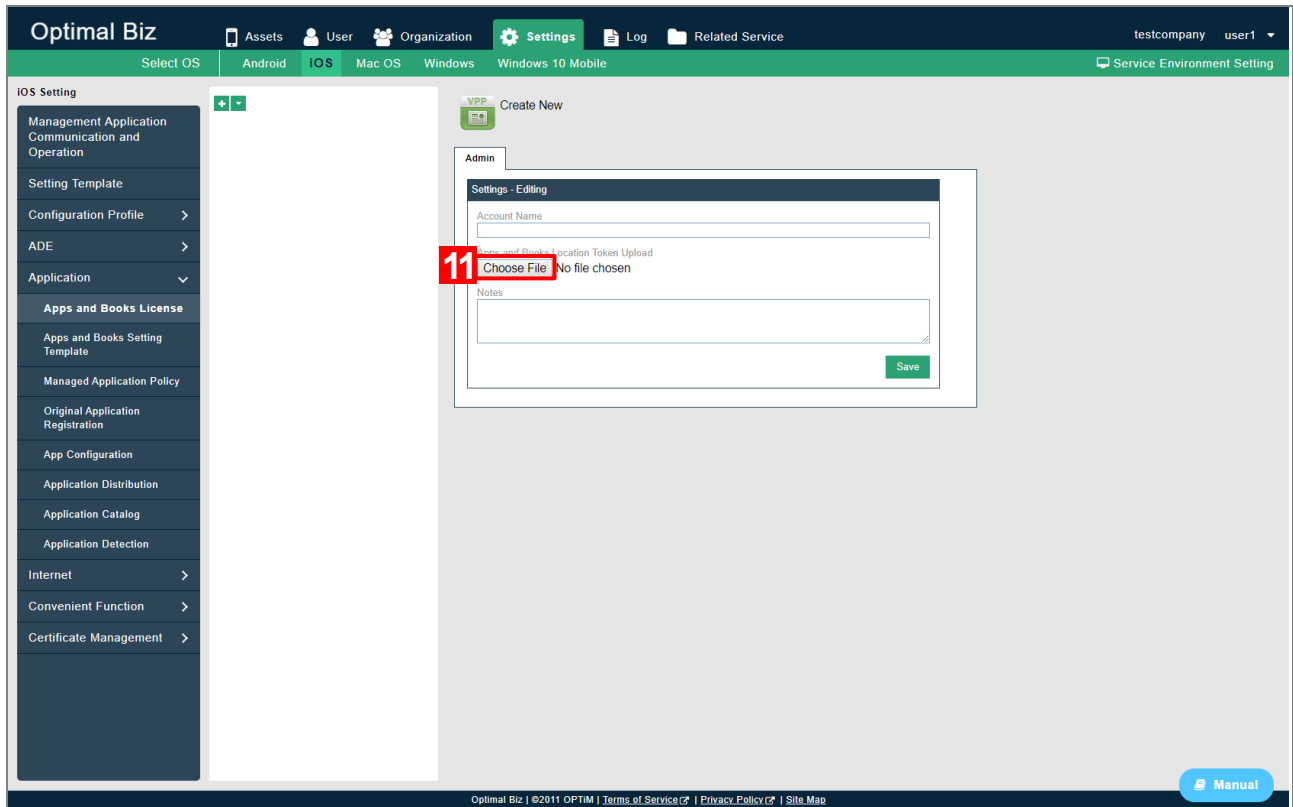
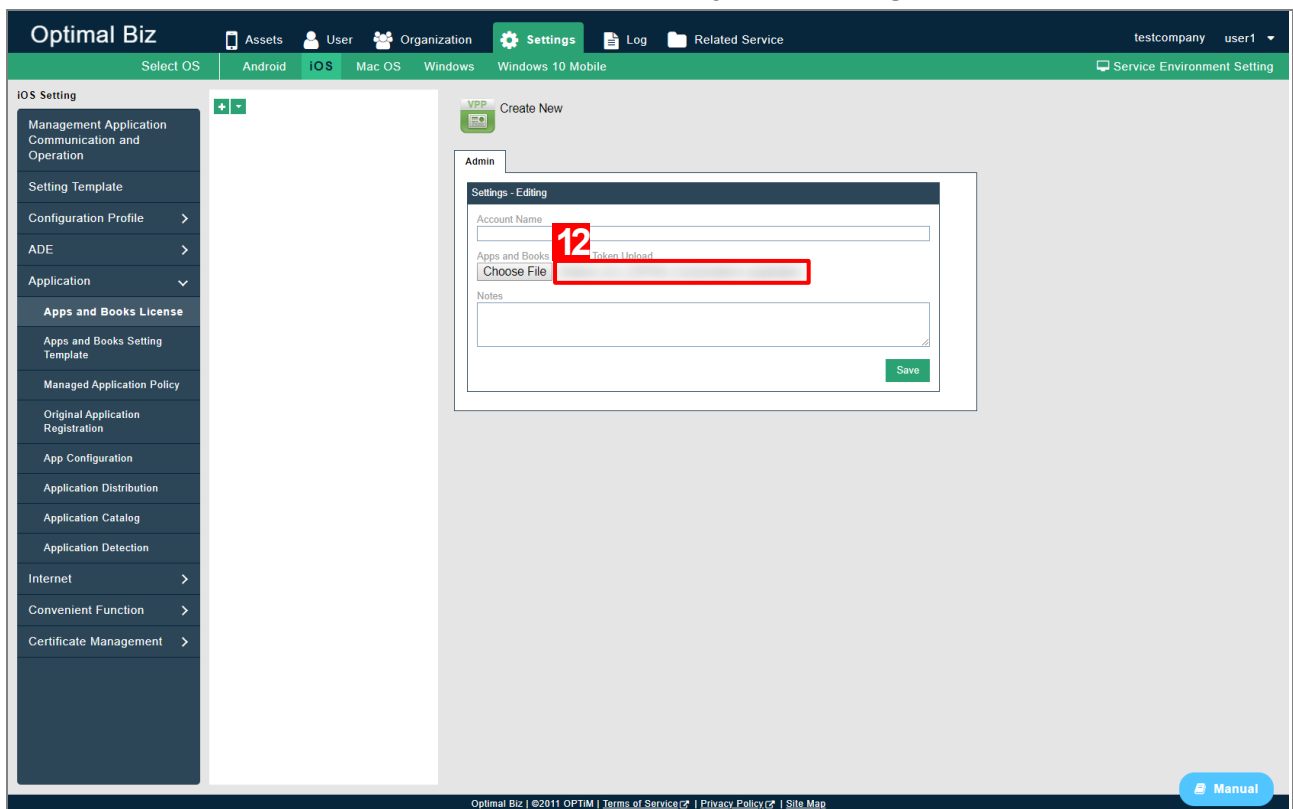
**[12] Confirm that the name of the selected file is displayed on the right side of [Choose file].**

**[13] Enter "Account Name" and "Notes" if necessary.**

- ☑ We recommend entering the Apple ID used for the acquisition of the Apps and Books Location Token and the acquisition date in "Notes".

**[14] Click [Save].**

⇒ The information of the Apps and Books Location Token you select and enter is saved.

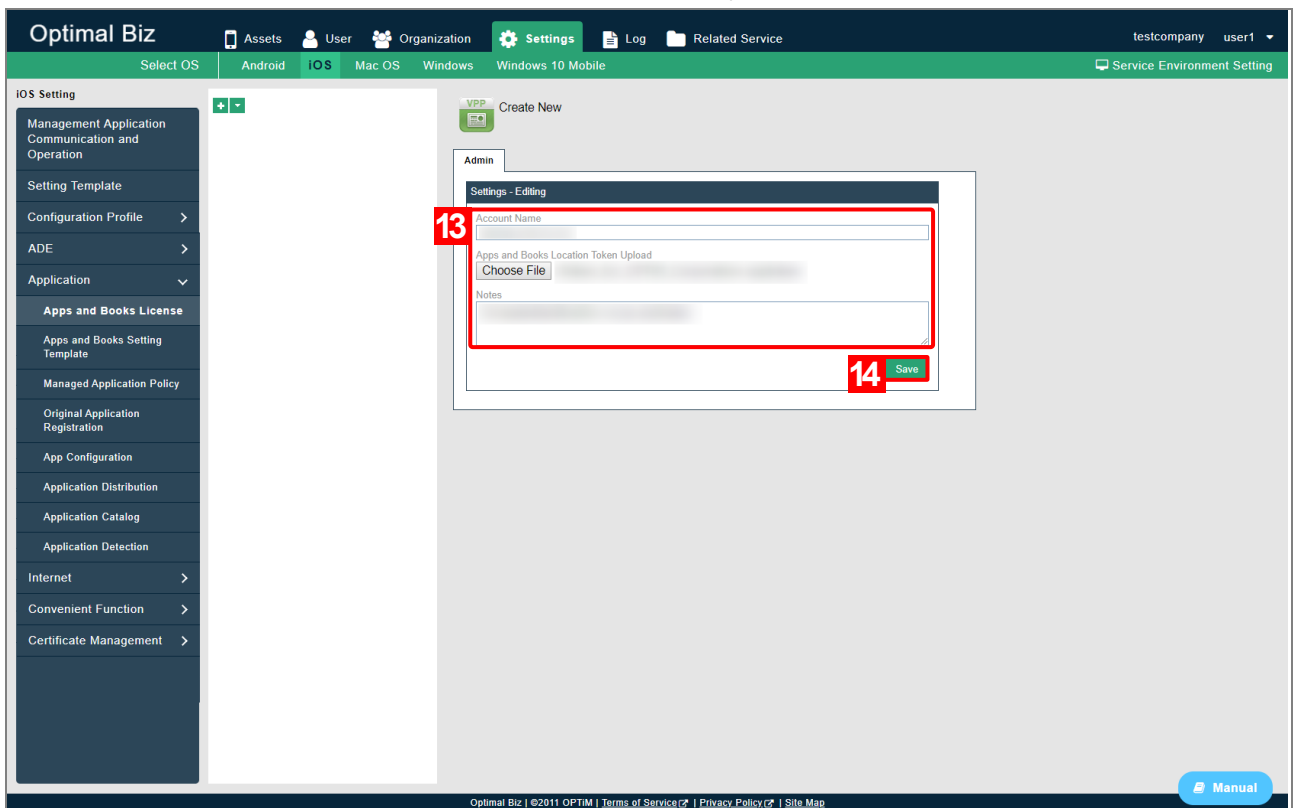
**[15] The update is completed. Confirm that "Created Apps and Books license." is displayed.**

⇒ (A) "Token Expiration Date" is updated.

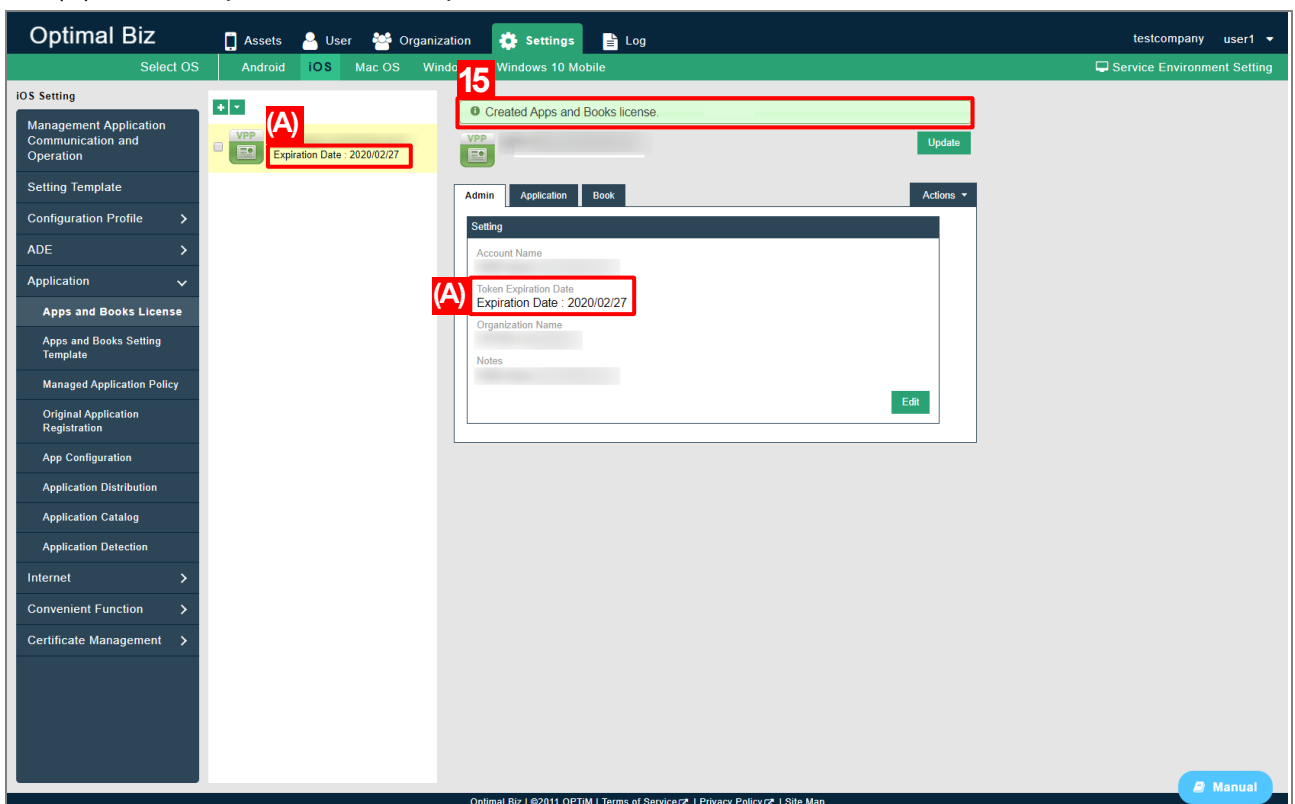

## 3.2 Updating Apps and Books Location Token

---

You need to update the Apps and Books Location Token within one year before it expires. For details, refer to the following.

 <ABM Server Token Annual Update Manual>

## 3.3 Procedure to deliver application/books

---

For details on how to deliver applications/books, refer to the following.

 <Apps and Books Operation Manual>

---

## 4 Appendix

Describes the following items.

Item	Page
<a href="#">References</a>	<a href="#">30</a>
<a href="#">Cautions</a>	<a href="#">30</a>
<a href="#">Limitations</a>	<a href="#">30</a>
<a href="#">The list of log</a>	<a href="#">30</a>

## 4.1 References

---

### ◆ Apple Business Manager Help

 <https://help.apple.com/businessmanager/>

## 4.2 Cautions

---

Refer to the following on the cautoons during operation.

 "Cautions" – "Appendix" in <Automated Device Enrollment (ADE) Operation Manual>

## 4.3 Limitations

---

Refer to the following on the limitations during operation.

 "Limitations" – "Appendix" in <Automated Device Enrollment (ADE) Operation Manual>

## 4.4 The list of log

---

When ADE is introduced, the logs that can be checked on the log screen of the management site. For details, reter to the following.

 "The list of log" – "Appendix" in <Automated Device Enrollment (ADE) Operation Manual>